

Specifications

NKLC1

- * Stroke Length: 400mm (option)
- * Color: Grey
- * Limit Switch: Built-in
- * Duty Cycle: 10%, max 2min continuous use
- * IP Grade: IP54
- * Operating Temperature: +5°C~+40°C
- * Standard: EN60601/UL60601
- * Optional: Hall sensor



Load and Speed

Dynamic Load Push(N)	2000
Off-center Load Capacity	Max 1000N at 400mm lever arm length
Static Load(N)	2000
Input(VDC)	24
Speed at Full Load(mm/s)	10

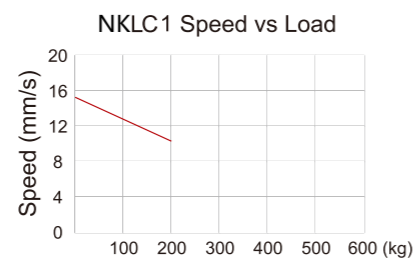
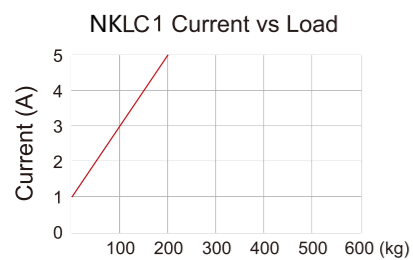

Dimensions

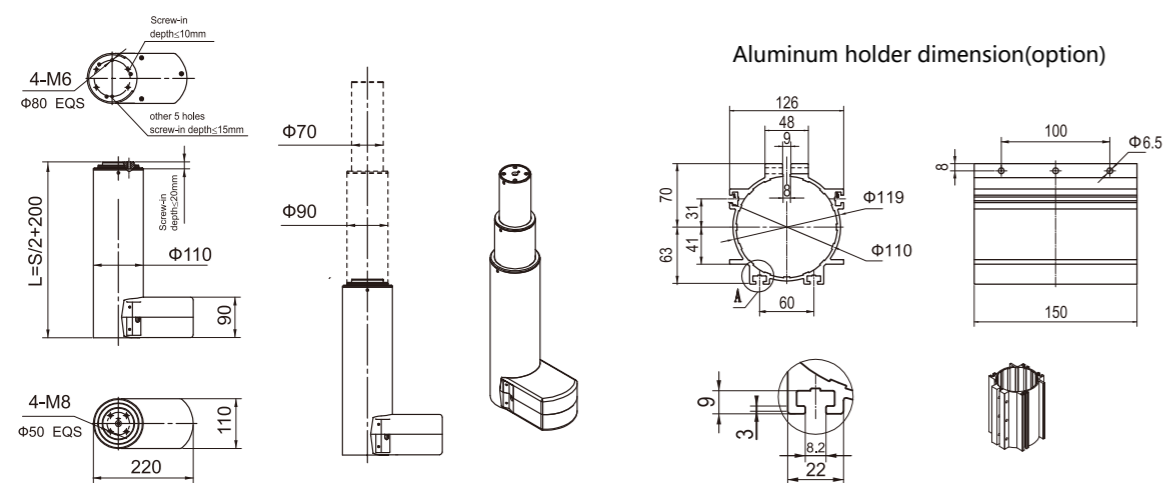

Specifications

NKLC2-2

- * Stroke Length: 100~400mm (option>400)
- * Color: Grey
- * Limit Switch: Built-in
- * Duty Cycle: 10%, max 2min continuous use
- * IP Grade: IP54
- * Operating Temperature: +5°C~+40°C
- * Standard: CE
- * Optional: Hall sensor



Load and Speed

Dynamic Load Push(N)	6000	4000	2000
Dynamic Load Pull(N)	6000	4000	2000
Static Load Push(N)	6000	4000	2000
Static Load Pull(N)	6000	4000	2000
Input(VDC)	24		
Off-center Load Capacity	Max 1000N at 500mm lever arm length		
Speed at Full Load(mm/s)	3	4	9

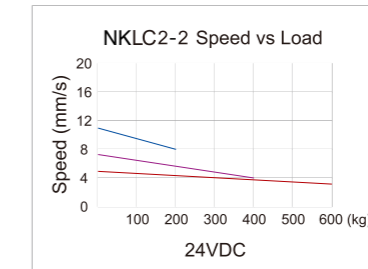
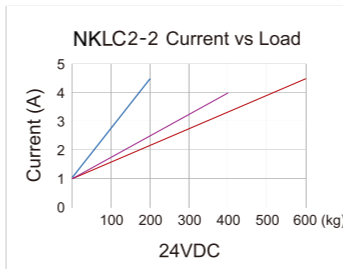

Dimensions

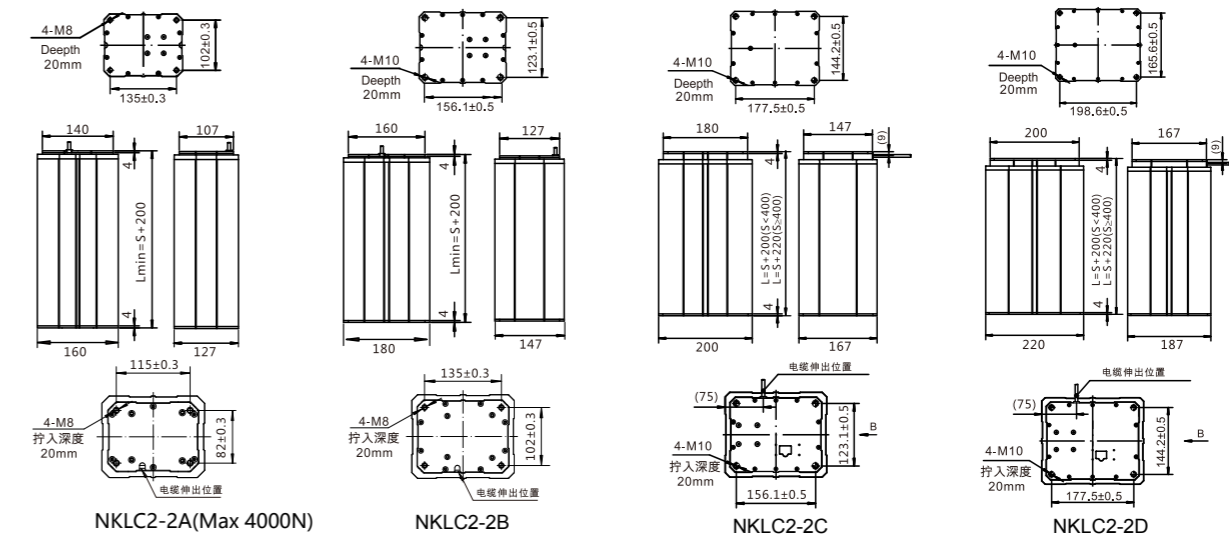

Specifications

NKLC2-3

- * Stroke Length: 100~400mm (option>400)
- * Color: Grey
- * Limit Switch: Built-in
- * Duty Cycle: 10%, max 2min continuous use
- * IP Grade: IP54
- * Operating Temperature: +5°C~+40°C
- * Standard: CE
- * Optional: Hall sensor



Load and Speed

Dynamic Load Push(N)	2000
Dynamic Load Pull(N)	2000
Static Load Push(N)	2000
Static Load Pull(N)	2000
Input(VDC)	24
Off-center Load Capacity	Max 1000N at 500mm lever arm length
Speed at Full Load(mm/s)	10

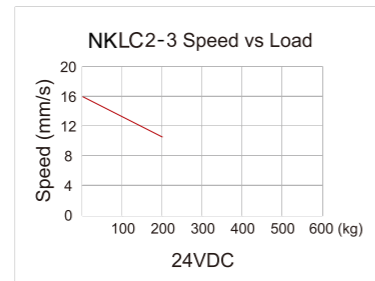
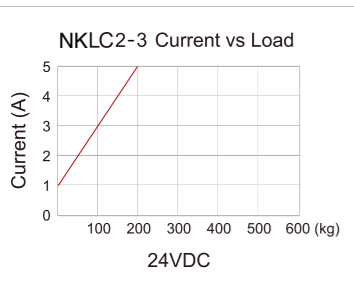

Dimensions

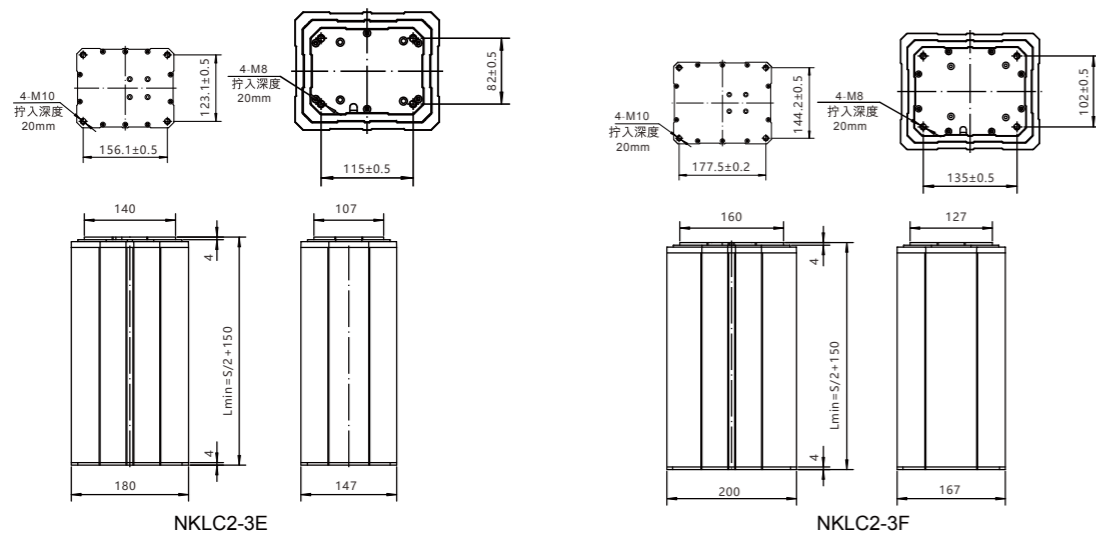

Specifications

NKLC3-2

- * Stroke Length: 100~400mm (option>400)
- * Color: Black/Grey
- * Limit Switch: Built-in
- * Duty Cycle: 10%, max 2min continuous use
- * IP Grade: IP43
- * Operating Temperature: +5°C~+40°C
- * Standard: CE/UL
- * Optional: Hall sensor



Load and Speed

Dynamic Load Push(N)	4000	2000
Dynamic Load Pull(N)	4000	2000
Static Load Push(N)	4000	2000
Static Load Pull(N)	4000	2000
Input(VDC)	24	12
Speed at Full Load(mm/s)	4	9
Input(VDC)	12	5
Speed at Full Load(mm/s)	3.5	5

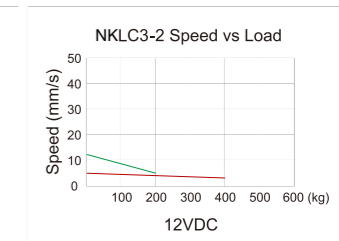
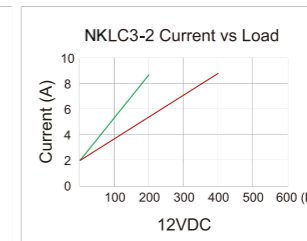
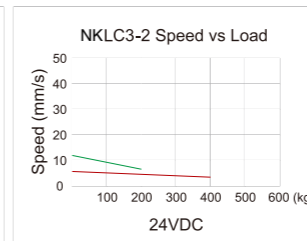
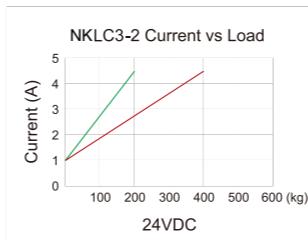

Dimensions

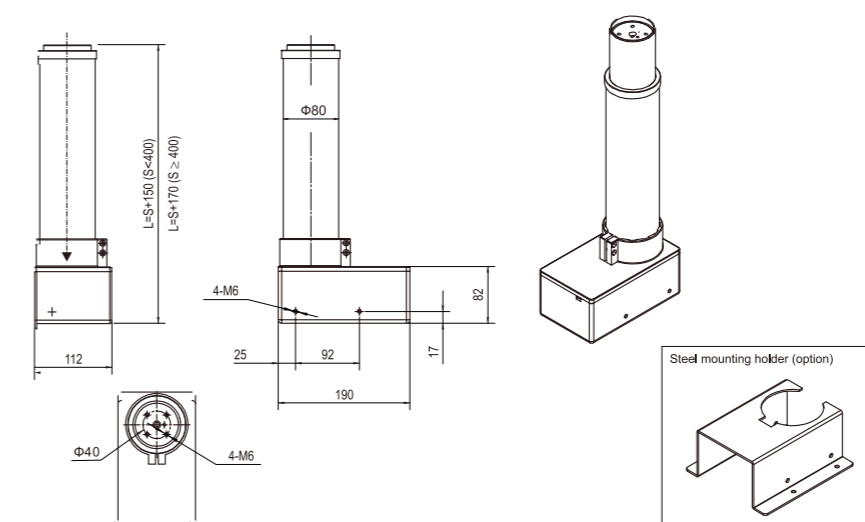

Specifications

NKLC3-3

- * Stroke Length: 100~400mm (option>400)
- * Color: Grey
- * Limit Switch: Built-in
- * Duty Cycle: 10%, max 2min continuous use
- * IP Grade: IP43
- * Operating Temperature: +5°C~+40°C
- * Standard: CE/UL
- * Optional: Hall sensor



Load and Speed

Dynamic Load Push(N)	1200
Dynamic Load Pull(N)	1200
Static Load Push(N)	1200
Static Load Pull(N)	1200
Input(VDC)	24
Speed at Full Load(mm/s)	10
Input(VDC)	12
Speed at Full Load(mm/s)	8

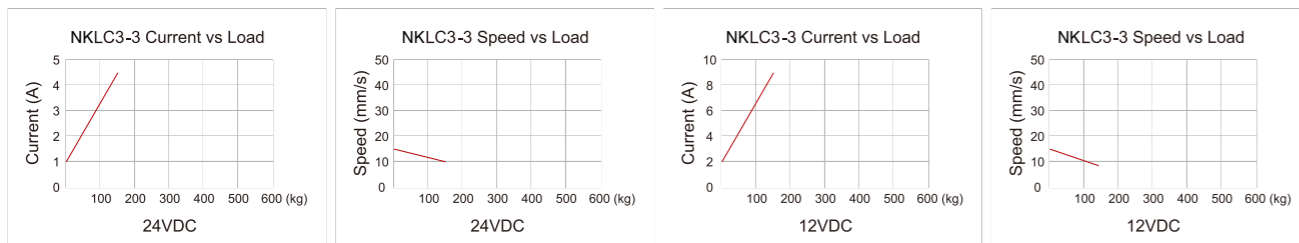

Dimensions

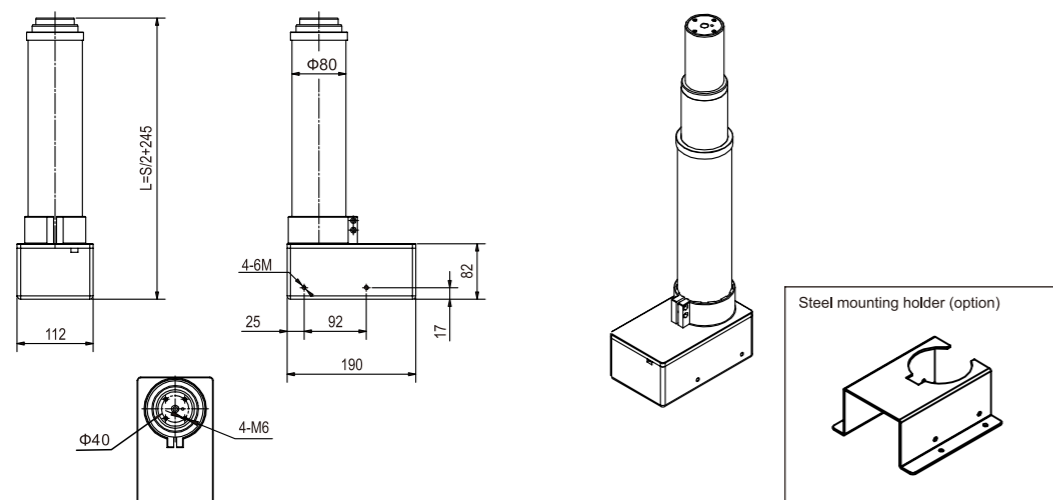

Specifications

NKLC4-2

- * Stroke Length: 100~400mm (option>400)
- * Color: Black/Grey
- * Limit Switch: Built-in
- * Duty Cycle: 10%, max 2min continuous use
- * IP Grade: IP43
- * Operating Temperature: +5°C~+40°C
- * Standard: CE/UL60601
- * Optional: Hall sensor



Load and Speed

Dynamic Load Push(N)	6000	4000	2000
Dynamic Load Pull(N)	6000	4000	2000
Static Load Push(N)	6000	4000	2000
Static Load Pull(N)	6000	4000	2000
Input(VDC)	24		
Speed at Full Load(mm/s)	3	4	7
Input(VDC)	12		
Speed at Full Load(mm/s)	3	4	5

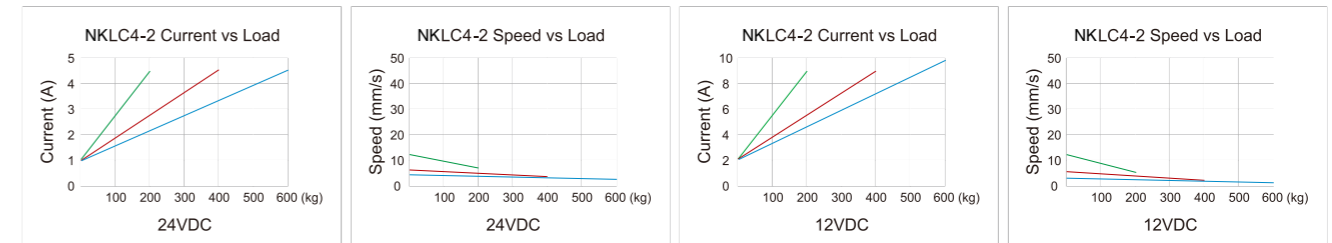

Dimensions

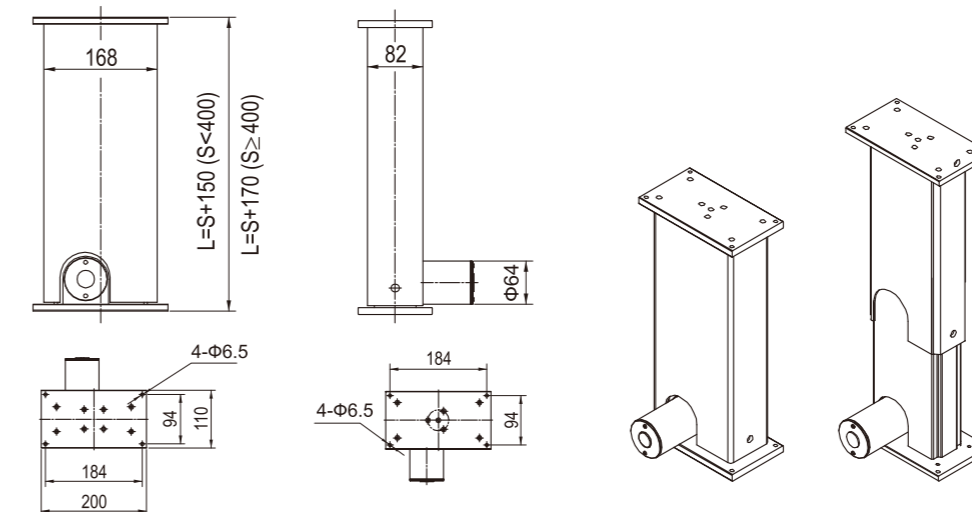

Specifications

NKLC4-3

- * Stroke Length: 100~400mm (option>400)
- * Color: Black/Grey
- * Limit Switch: Built-in
- * Duty Cycle: 10%, max 2min continuous use
- * IP Grade: IP43
- * Operating Temperature: +5°C~+40°C
- * Standard: CE/UL60601
- * Optional: Hall sensor



Load and Speed

Dynamic Load Push(N)	2000
Static Load Push(N)	2000
Static Load Pull(N)	2000
Input(VDC)	24
Speed at Full Load(mm/s)	10
Input(VDC)	12
Speed at Full Load(mm/s)	7

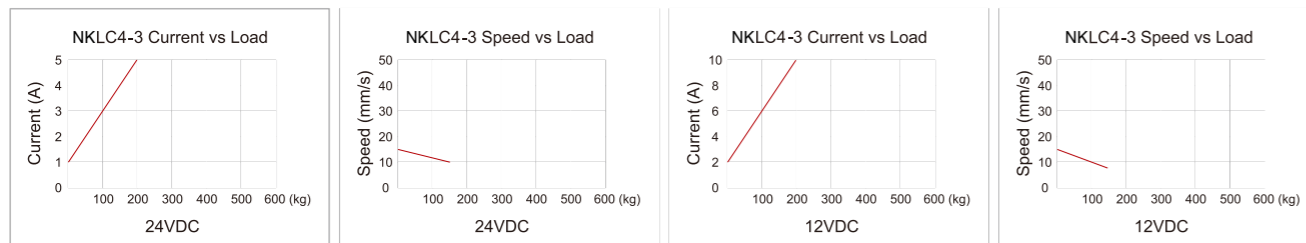

Dimensions

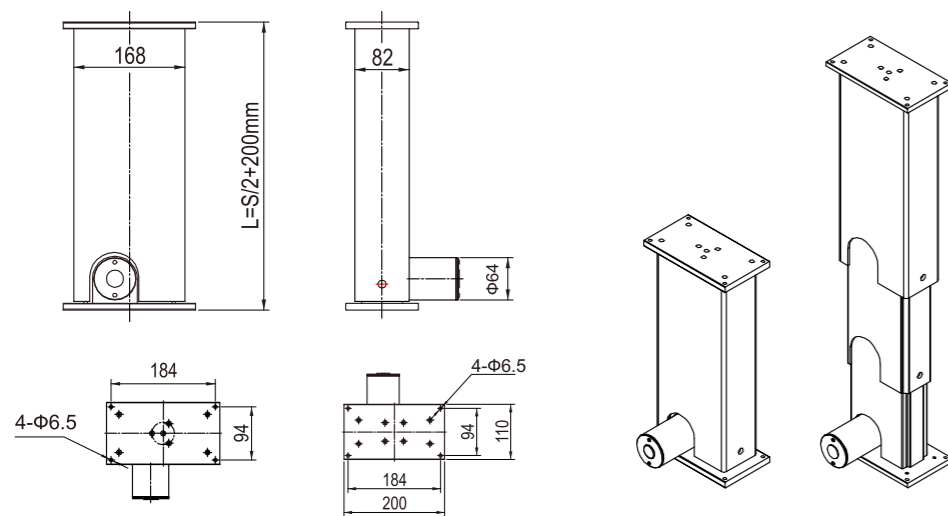

Specifications

NKLC5

- * Stroke Length: 420mm
- * Color: Grey
- * Limit Switch: Built-in
- * Duty Cycle: 10%, max 2min continuous use
- * IP Grade: IP54
- * Operating Temperature: +5°C~+40°C
- * Standard: CE



Load and Speed

Dynamic Load Push(N)	1000
Dynamic Load Pull(N)	1000
Static Load(N)	1000
Off-center Load Capacity	Max 250N
Speed at Full Load(mm/s)	14

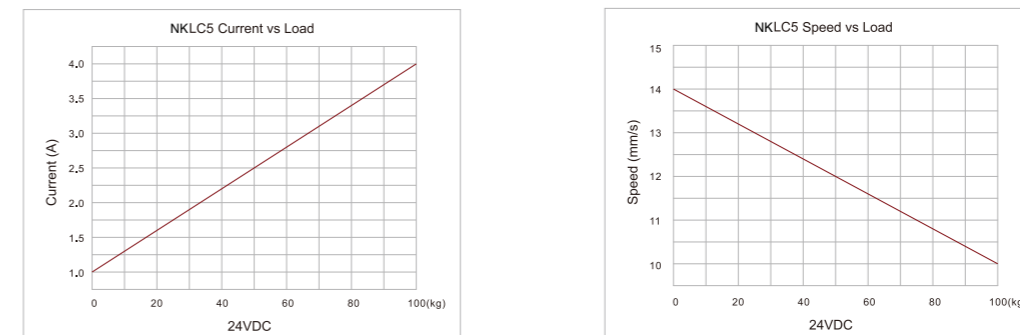

Dimensions

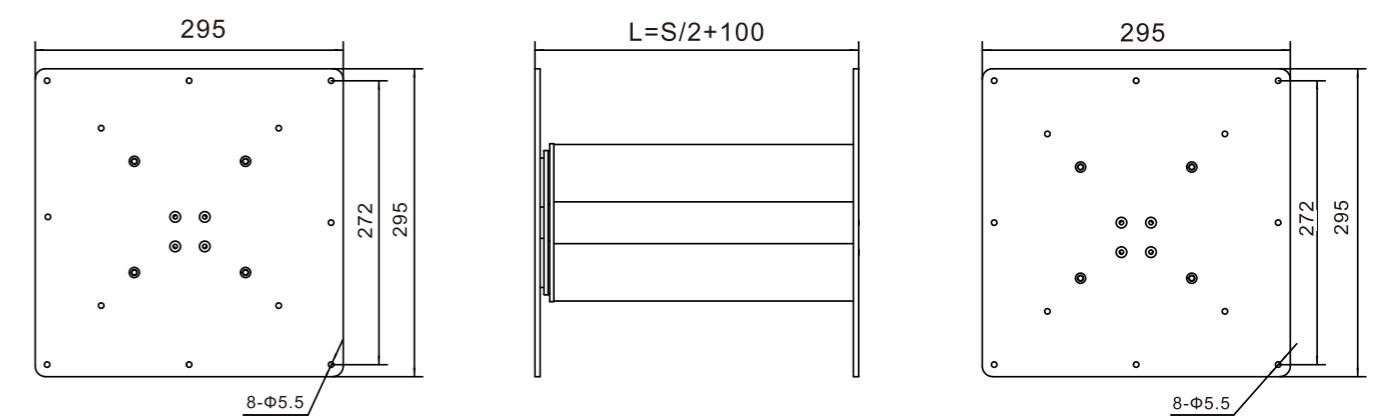

Specifications

NKLC22

- * Stroke Length: 300~600mm (option)
- * Color: Grey
- * Duty Cycle: 10%, max 2min continuous use, rest 18 minutes
- * IP Grade: IP43
- * Operating Temperature: +5°C~+40°C
- * Option: With hall-sensor(apply for synchronize or memory function)
- * Description: NKLC22 is designed for linear lifting column with one of 24VDC actuator inside
- * Features: Low noise; nice design; anodised aluminium; strong and waterproof



Load and Speed

Spindle Pitch	4	5	5
Dynamic Load Push(N)	6000	4000	2000
Self-lock(N)	6000	4000	2000
Bending Force Max(static)(NM)	900	900	900
Bending Force Max(dynamic)(NM)	400	400	400
No-load Speed(mm/s)	5	6.5	13
Load Speed(mm/s)	3	4	9
Load Current(A)	5.2	4.5	4.2

Comments to table

- * The above measures are made in connection with 24V DC stabilized voltage supply.
- * NAKIN control boxes are designed so that they will short-circuit the motor terminals (poles) of the actuator(s) when the actuator(s) are not running. This solution gives the actuator(s) a higher self-locking ability. If the actuator(s) are not connected to a NAKIN control box, the terminals of the motor must be short-circuited to achieve the self-locking ability of the actuator.
- * The max bending force is tested with stroke of the column is less than 300mm.
- * The max stroke is 300mm with loading force is 6000N
The max stroke is 400mm with loading force is 4000N
The max stroke is 600mm with loading force is 2000N

Dimensions

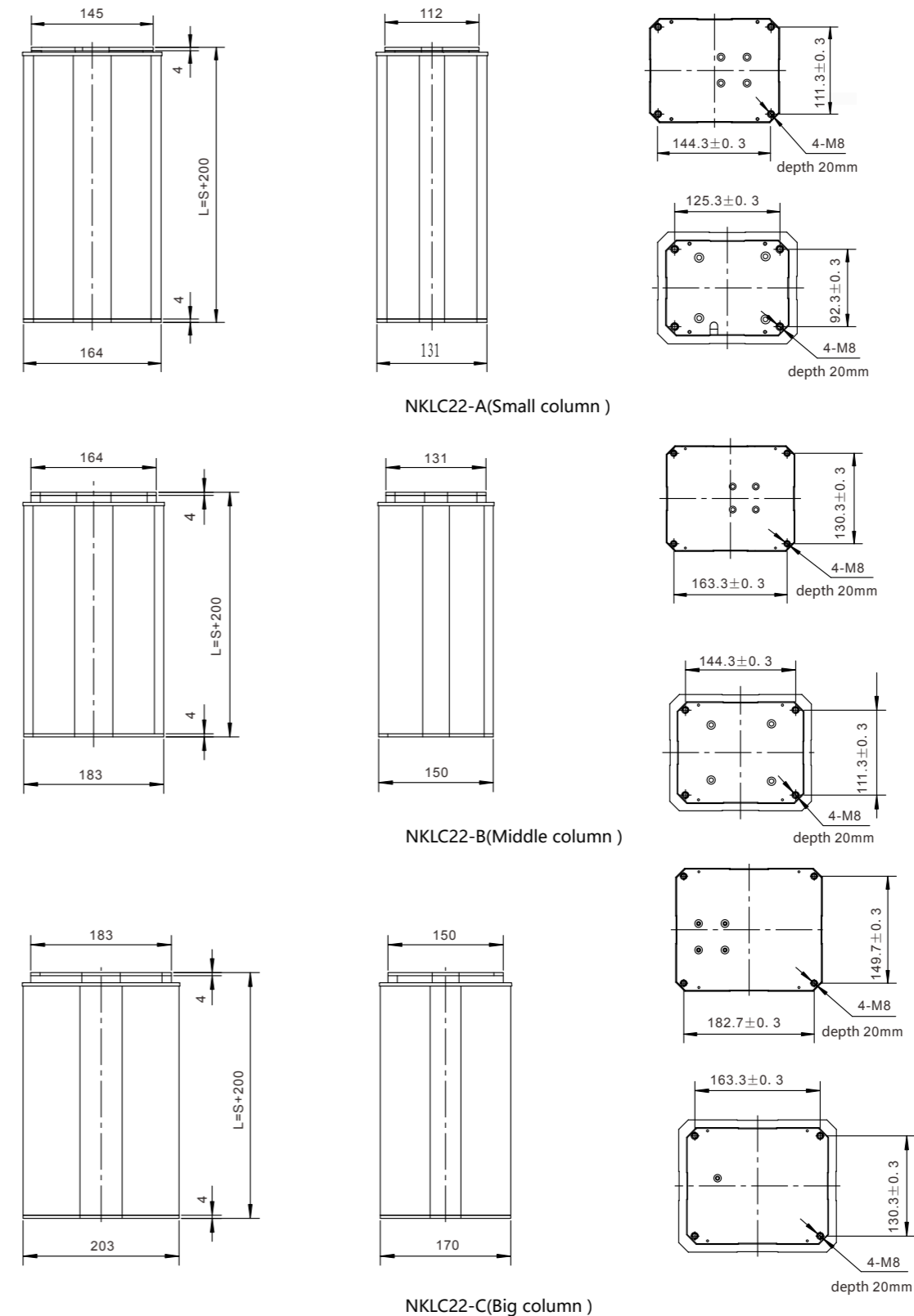

L=S+200(S<400)
L=S+220(400≤S≤600)

Specifications

NKLC23

- * Stroke: Max 400mm
- * Color: Grey
- * Built-in electrical limited switch-not adjustable
- * Duty Cycle: 10%, max 2min continuous use, rest 18 minutes
- * IP Grade: IP54
- * Operating Temperature: +5°C~+40°C
- * Option: With hall-sensor(apply for synchronize or memory function)
- * DC 24V Permanent Magnet Motor
- * Built-in dimension: 350mm(+/-4)
- * Stroke length: Max 400mm(+/-4)
- * Load in push: 2000N
- * Static bending moment: 1000NM
- * Dynamic bending moment: 500NM
- * Noise level: 48dB
- * Standard: CE/IEC60601-1



Load and Speed

Spindle Pitch	4
Dynamic Load Push(N)	2000
Self-lock(N)	2000
Bending Force Max(static)(NM)	1000
Bending Force Max(dynamic)(NM)	500
No-load Speed(mm/s)	8.2
Load Speed(mm/s)	5.8
Load Current(A)	7.1

Comments to table

- * The above measures are made in connection with 24V DC stabilized voltage supply.
- * NAKIN control boxes are designed so that they will short-circuit the motor terminals (poles) of the actuator(s) when the actuator(s) are not running. This solution gives the actuator(s) a higher self-locking ability. If the actuator(s) are not connected to a NAKIN control box, the terminals of the motor must be short-circuited to achieve the self-locking ability of the actuator.

Dimensions

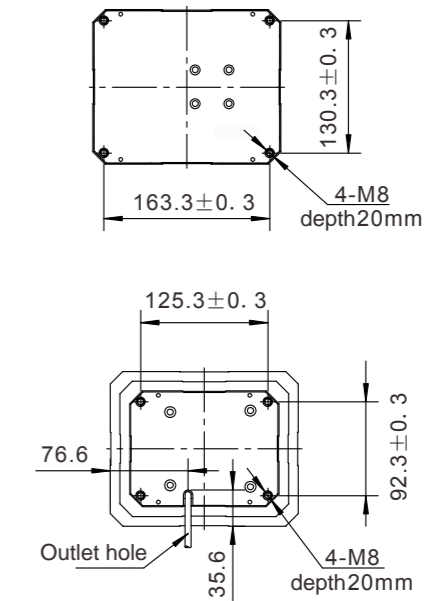
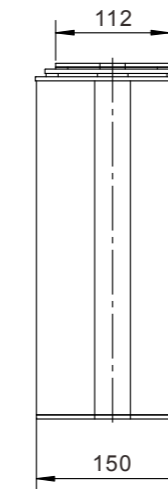
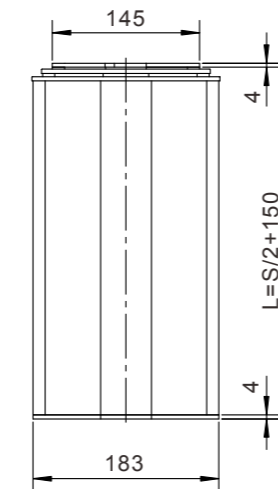

NKLC23-E(Small column)

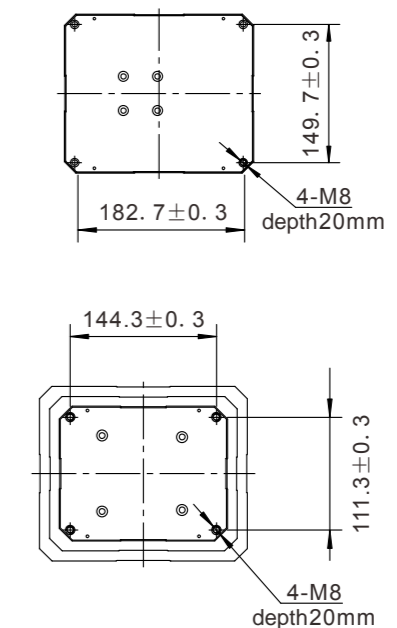
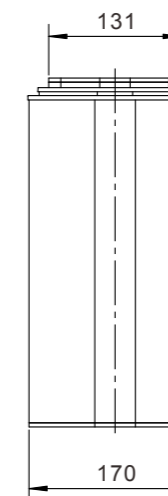
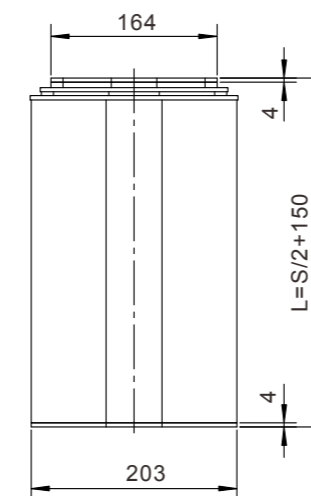

NKLC23-F(Big column)

$L=S/2+150$

Specifications

TV lifts NKLC6

- * In applications ranging from 25" to 60" TV
- * Can set different height and select running
- * Control mode: Handset and remote control



Parameter

Type	NKLC6-650	NKLC6-1000
Max load capacity(N)	600	
Static load(N)	700	
Input voltage(VAC)	110-240	
Load speed(mm/s)	25	
Min height(mm)	570	810
Max height(mm)	1220	1810
Color	Black	
Duty cycle	10%, max 2min continuous use, rest 18 minutes	
IP grade	IP20	
Operating Temperature	+5°C~+40°C	
Standard	CE/UL	
Packaging	670*310*250	900*310*235
Weight	16.5kg	21kg



Dimensions

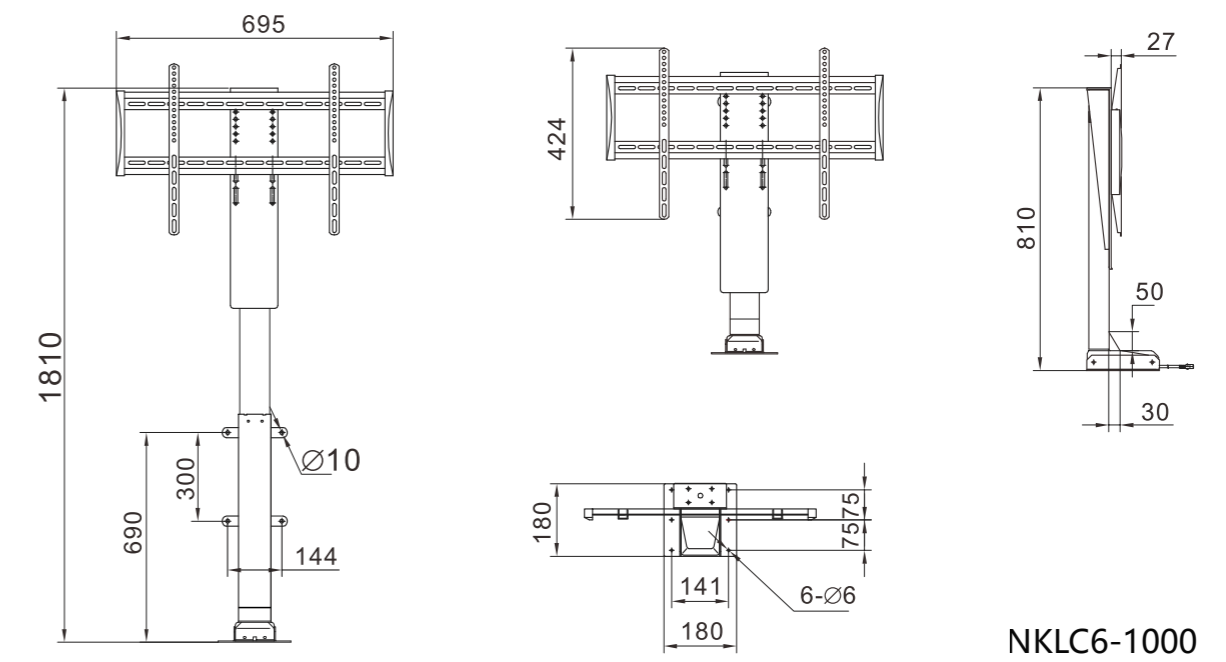
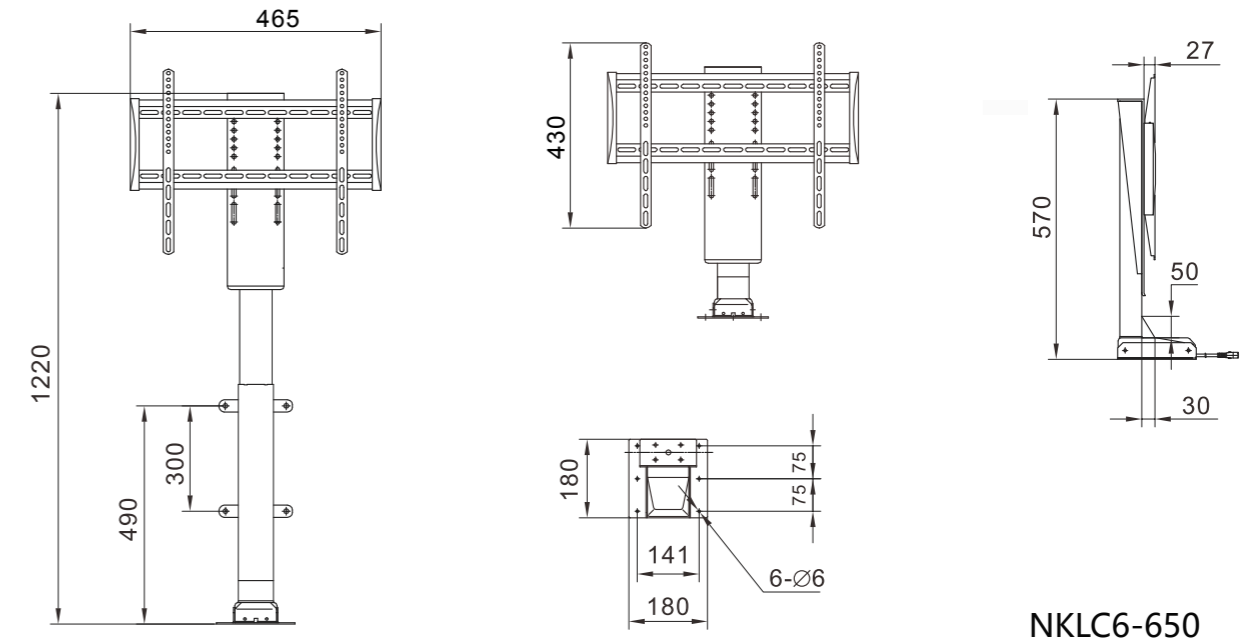

Specifications

NKLC32-2K

- * The Static Bending Moment: 1000NM
- * The Dynamic Bending Momen: 500NM
- * Output Voltage: 33VDC (NKCB12 control box)
- * No-load Current : $\leq 3.5A$
- * Color: Silver Gray
- * IP Grade: IPXX
- * Load capacity: 1500N
- * Low noise level: $\leq 60dB$ (The environment noise level $\leq 40dB$)

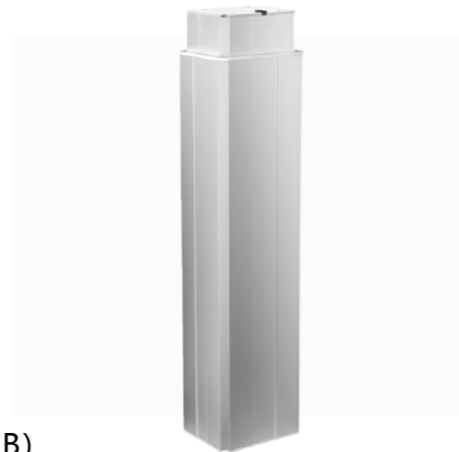

Load and Speed

Rated load(N)	1500
Reversing locking(N)	1500
Current at rated Load(A)	7
No-load Speed(mm/s)	30
Load Speed(mm/s)	30
Duty cycle	10%
Stroke length(mm)	400
Retracted length(mm)	650

Dimensions

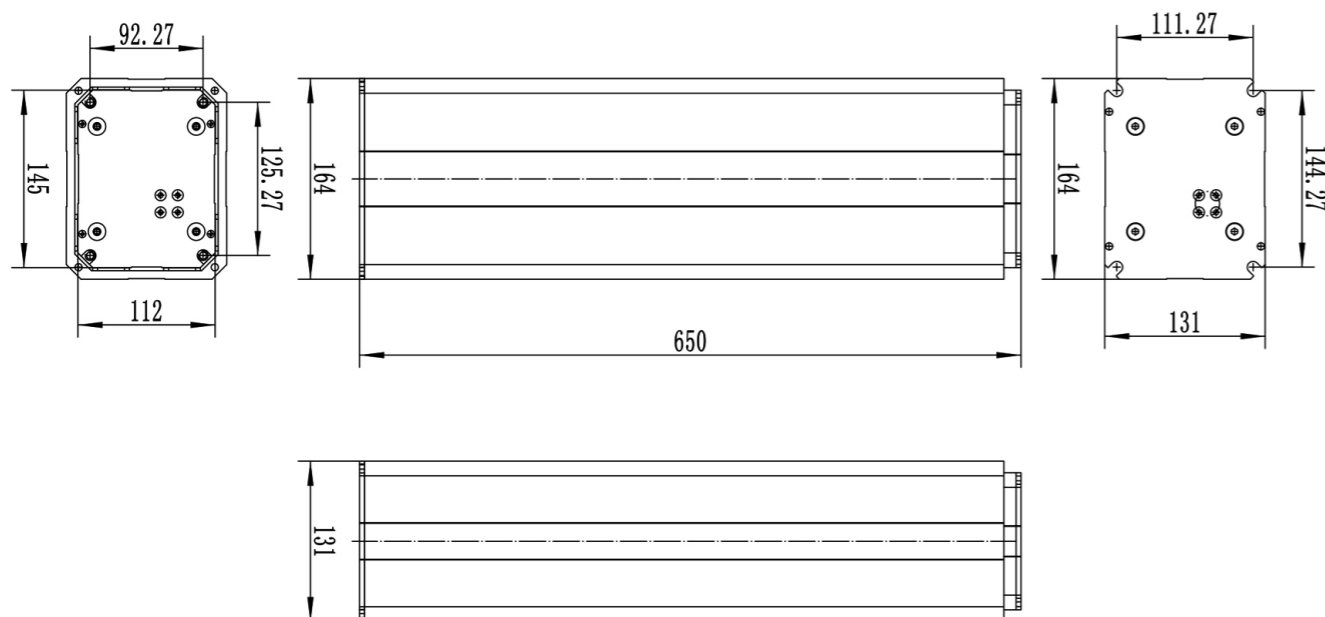

Specifications

NKLC4-2N

- * Stroke Length: 100-400mm (+/-2mm)
- * Electronic Limit Switches
- * Speed: Up to 11.5mm/s at Full Load
- * Surface : Spray molding process, White
- * Low noise level
- * IP Grade: IP43
- * Operating Temperature: 0~+50°C
- * Duty Cycle: 10%, max 2min continuous use, rest 18 minutes
- * Optional: Hall Sensor
- * Application field: Home Line, Medical Line



Load and Speed

Spindle Pitch(mm)	2.5
Max. Load Push(N)	1000
Self-lock(N)	1000
Input Voltage(VDC)	24
Installation dimension(mm)	$L=S+145$ ($100 < S \leq 400$)
No-load Speed(mm/s)	14
Load Speed(mm/s)	11.5
Current at Full Load(A)	≤ 4

Dimensions

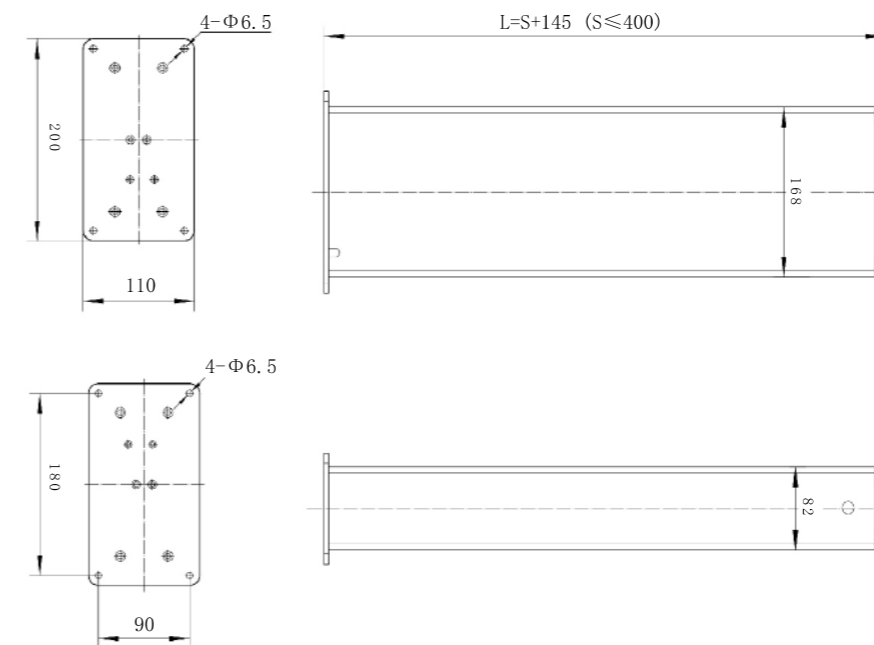

Specifications

NKLC8-2-S

- * 2mm thickness round tube and 3mm optimized motor housing design for extra strength and stability
- * The tube is no hole design
- * Max. load capacity is 800N per column
- * Self Locking: 1200N
- * Typical current at rated Load(A): 5A
- * Fit with NKCB11-14 series control boxes to realize stable speed 32mm/s
- * Low noise level ≤50dB
- * Max. Bending moment: 150N.m
- * Standard installation length: 650mm
- * Standard stroke length: 500mm
- * Column dimensions: outer tube diameter: Ø70mm, inner tube diameter: Ø 63.5mm
- * Motor housing dimension: 190x96x48mm
- * Motor: Self made high power motor
- * Hall sensor enabling parallel drive
- * Surface: Powder coating with standard
- * Color: White, Black, Grey
- * Optional: Customized colors; Compatible with several different styles of feet
- * Duty Cycle: 10%, max 2min continuous use, rest 18 minutes
- * Operating Temperature: -10°C~+70°C



Dimensions

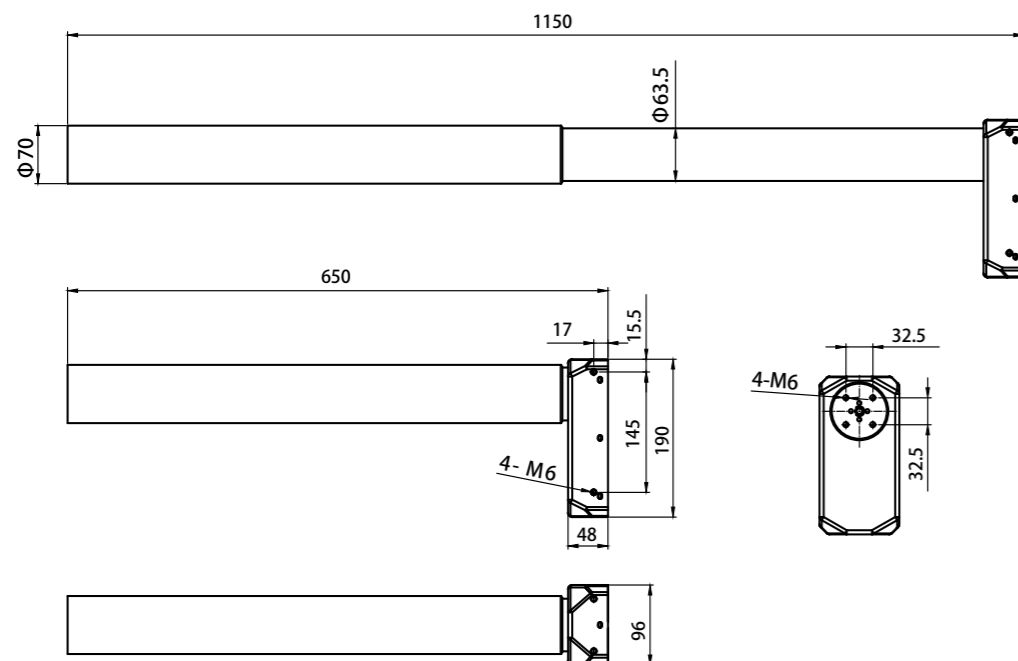

Specifications

NKLC8-3-S

- * 2mm thickness round tube and 3mm optimized motor housing design for extra strength and stability
- * The tube is no hole design
- * Max. load capacity is 800N per column
- * Self Locking: 1200N
- * Typical current at rated Load(A): 5A
- * Fit with NKCB11-14 series control boxes to realize stable speed 35mm/s
- * Low noise level ≤50dB
- * Max. Bending moment: 150N.m
- * Standard installation length: 560mm
- * Standard stroke length: 650mm
- * Column dimensions: outer tube diameter: Ø70mm, middle tube diameter: Ø 63.5mm, inner tube diameter: Ø 57mm
- * Motor housing dimension: 190x96x48mm
- * Motor: Self made high power motor
- * Hall sensor enabling parallel drive
- * Surface: Powder coating with standard
- * Color: White, Black, Grey
- * Optional: Customized colors; Compatible with several different styles of feet; PVC-free column; Bracket for crossbar
- * Duty Cycle: 10%, max 2min continuous use, rest 18 minutes
- * Operating Temperature: -10°C~+70°C



Dimensions

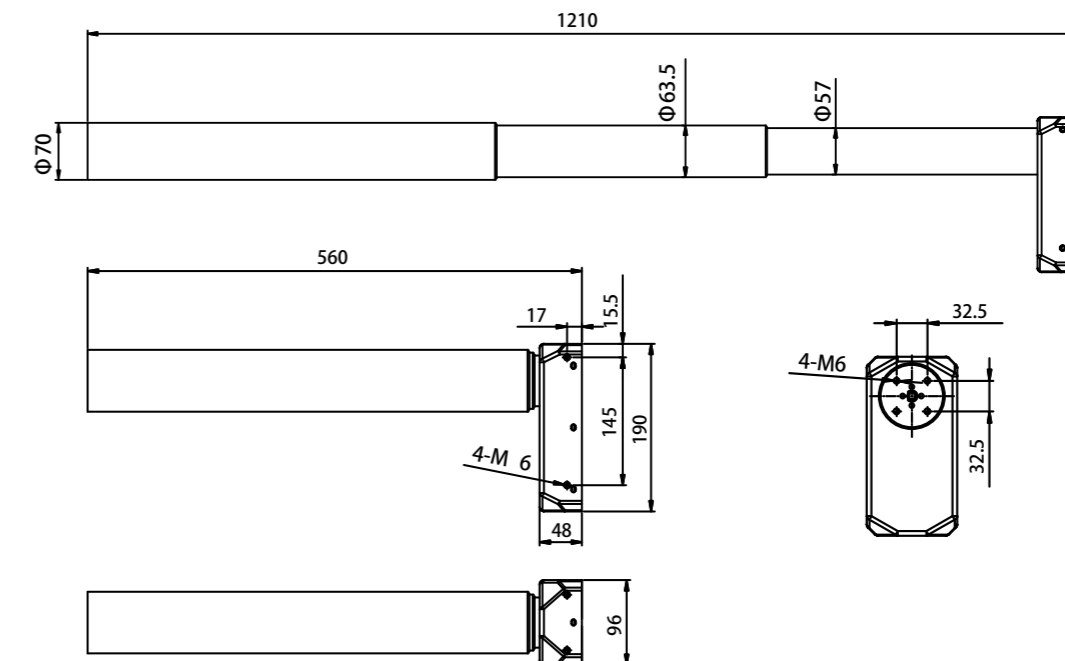

Specifications

NKLC9-2-S

- * 3mm optimized motor housing was designed for extra strength and stability
- * The tube is no hole design
- * Max. load capacity is 800N per column
- * Self Locking: 1200N
- * Typical current at rated Load(A): 5A
- * Fit with NKCB11-14 series control boxes to realize stable speed 32mm/s
- * Low noise ≤50dB
- * Max. Bending moment: 150N.m
- * Standard installation length: 650mm
- * Standard stroke length: 500mm
- * Column dimensions: outer tube: 80x50mm, inner tube:75x45mm
- * Motor housing dimension: 190x96x48mm
- * Motor: Self made high power motor
- * Hall sensor enabling parallel drive
- * Surface: Powder coating with standard
- * Color: White, Black, Grey
- * Optional: Customized colors; Compatible with several different styles of feet; PVC-free column; Bracket for crossbar
- * Duty Cycle: 10%, max 2min continuous use, rest 18 minutes
- * Operating Temperature: -10°C~+70°C



Dimensions

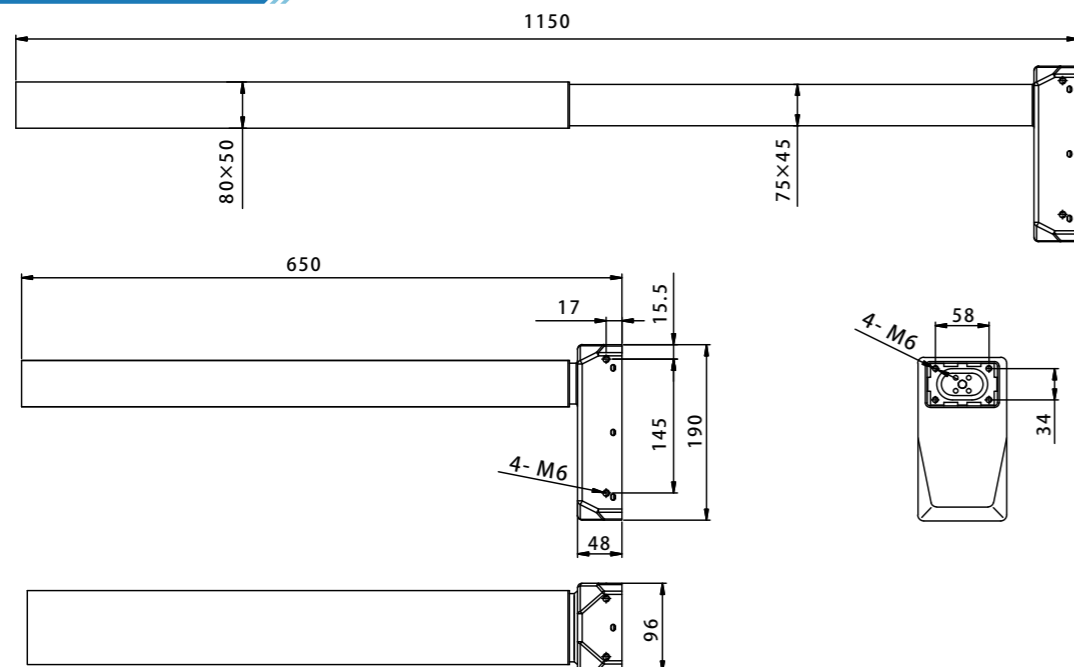

Specifications

NKLC9-3-S

- * Rectangle lifting column with 3mm optimized motor housing design and for extra strength and stability
- * The tube is no hole design
- * Max. load capacity is 800N per column
- * Self Locking: 1200N
- * Typical current at rated Load(A): 5A
- * Fit with NKCB11-14 series control boxes to realize stable speed 35mm/s
- * Low noise level ≤50dB
- * Max. Bending moment: 150N.m
- * Standard installation length: 560mm
- * Standard stroke length: 650mm
- * Column dimensions: outer tube: 80x50mm; middle tube:75x45mm; inner tube:70x40mm
- * Motor housing dimension: 190x96x48mm
- * Motor: Self made high power motor
- * Hall sensor enabling parallel drive
- * Surface: Powder coating with standard
- * Color: White, Black, Grey
- * Optional: Customized colors; Compatible with several different styles of feet; PVC-free column; Bracket for crossbar
- * Duty Cycle: 10%, max 2min continuous use, rest 18 minutes
- * Operating Temperature: -10°C~+70°C



Dimensions

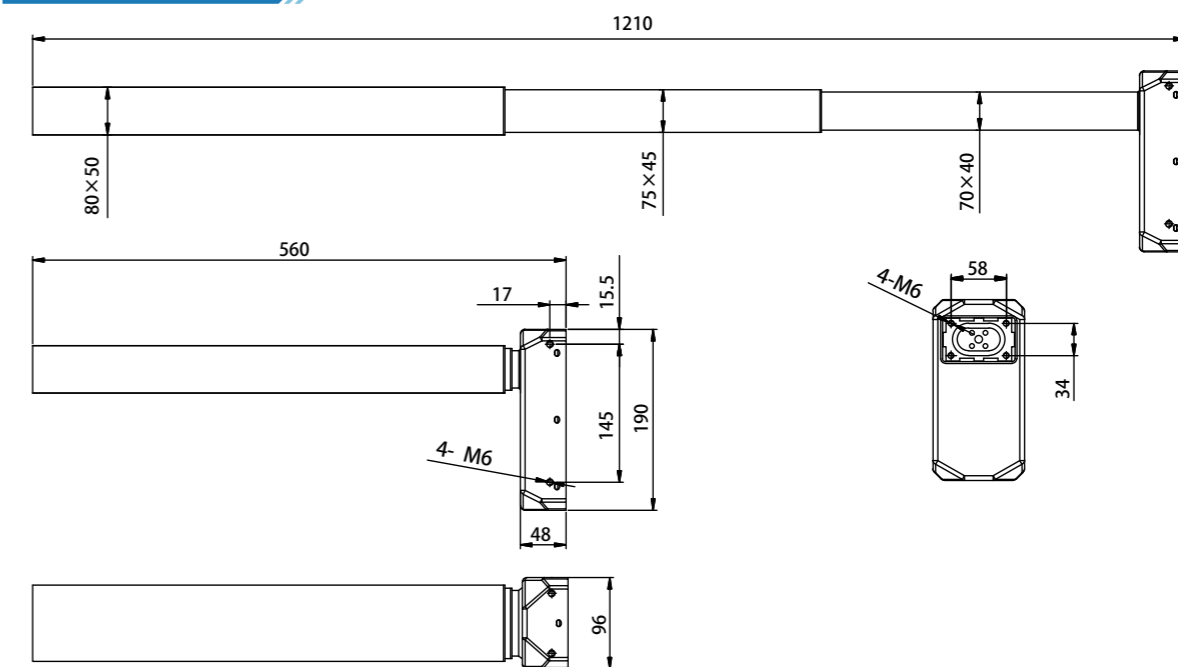

Specifications

NKLC9-2-R

- * 2mm motor housing with triangle support for extra strength and stability
- * The tube is no hole design
- * Max. load capacity is 800N per column
- * Self Locking: 1200N
- * Typical current at rated Load(A): 5A
- * Fit with NKCB11-14 series control boxes to realize stable speed 32mm/s
- * Low noise level $\leq 50\text{dB}$
- * Max. Bending moment: 150N.m
- * Standard installation length: 650mm
- * Standard stroke length: 500mm
- * Column dimensions: outer tube:80x50mm, inner tube:75x45mm
- * Motor housing dimension: 176x96x46mm
- * Motor: Self made high power motor
- * Hall sensor enabling parallel drive
- * Surface: Powder coating with standard
- * Color: White, Black, Grey
- * Optional: Customized colors; Compatible with several different styles of feet; PVC-free column
- * Duty Cycle: 10%, max 2min continuous use, rest 18 minutes
- * Operating Temperature: $-10^{\circ}\text{C}\sim+70^{\circ}\text{C}$



Dimensions

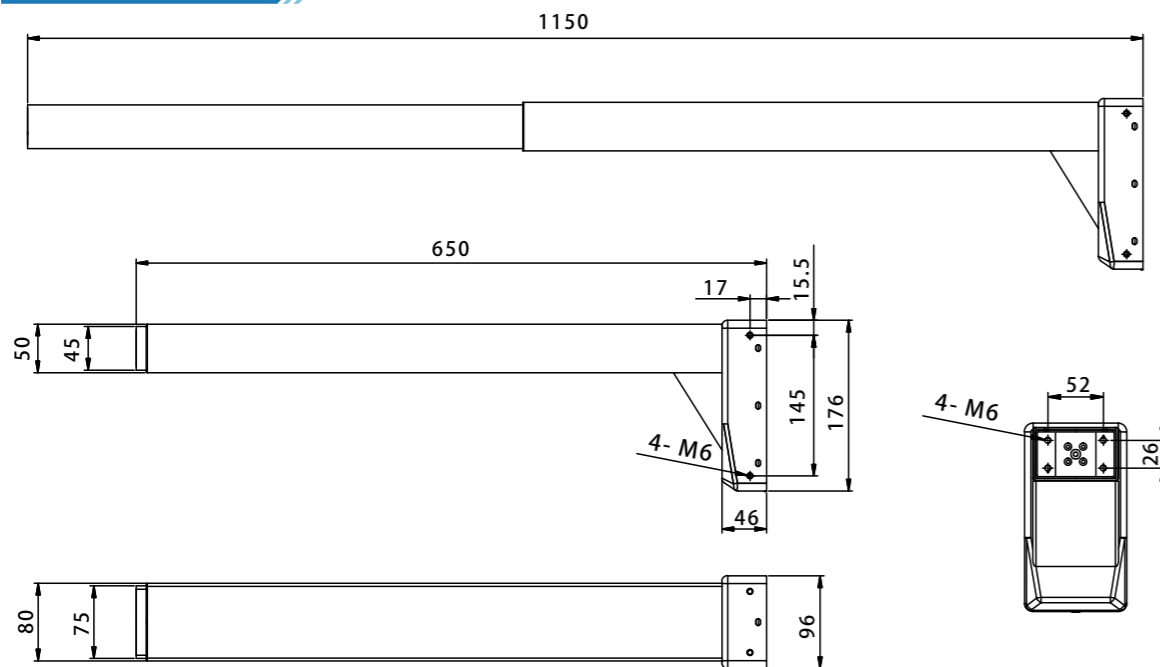

Specifications

NKLC9-3-R

- * NKLC9-3-R is a rectangle 3-segment no hole column, perfect for a wide range of different desk applications.
- * It is an upside down column, where the smallest tube is mounted on the foot construction, which is intended for desks without crossbar. This feature ensures an optimum freedom of design
- * The function of anti-collision minimize the risk of damages when desk collision with an obstacle
- * NKLC9-3-R is compatible with all the standard control boxes, and ensures a very low and pleasant noise level, and steady movement. Furthermore, the system has a very low standby power consumption less than 0.1W
- * Rectangle lifting column with 3mm optimised motor housing design and triangle support for extra strength and stability
- * The tube is no hole design
- * Max. load capacity is 800N per column
- * Fit with NKCB11-14 series control boxes to realize max speed 35mm/s
- * Low noise level $< 50\text{dB}$
- * Max. Bending moment: 150N.m
- * Standard installation length: 560mm
- * Standard stroke length: 650mm
- * Column dimensions: outer tube:80x50mm; middle tube:75x45mm; inner tube:70x40mm
- * Motor housing dimension: 176x96x46mm
- * Motor: Self made high power motor
- * Hall sensor enabling parallel drive
- * Color: White, Black, Grey
- * Optional: Customized colors; Compatible with several different styles of feet; PVC-free column
- * Duty Cycle: 10%, max 2min continuous use, rest 18 minutes
- * Operating Temperature: $-10^{\circ}\text{C}\sim+70^{\circ}\text{C}$



Dimensions

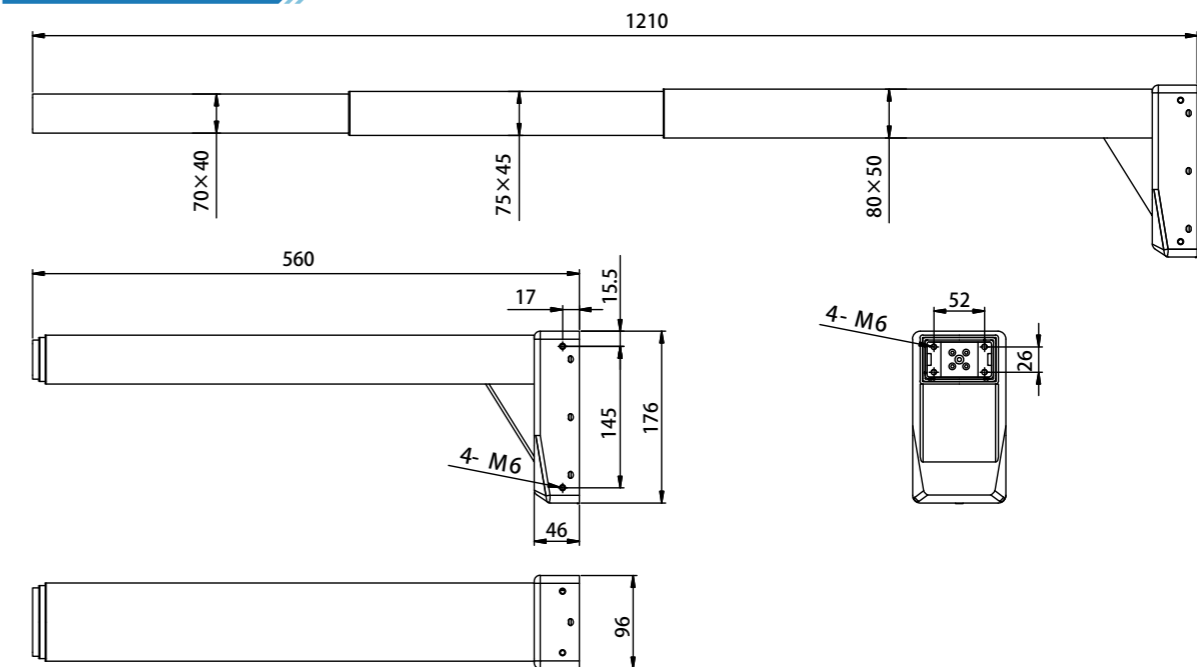

Specifications

NKLC10-3-S

- * With 3mm optimized motor housing design for extra strength and stability
- * The tube is no hole design
- * Max. load capacity is 800N per column
- * Self Locking: 1200N
- * Typical current at rated Load(A): 5A
- * Fit with NKCB11-14 series control boxes to realize max speed 35mm/s
- * Low noise level <50dB
- * Max Bending moment: 150N.m
- * Standard installation: 560mm
- * Standard stroke length: 650mm
- * Column dimensions: outer tube:90×60mm; middle tube:85×55mm; inner tube:80×50mm
- * Motor housing dimension: 190×96×48mm
- * Motor: Self made high power motor
- * Hall sensor enabling parallel drive
- * Color: White, Black, Grey
- * Optional: Customized colors; Compatible with several different styles of feet; PVC-free column
- * Duty Cycle: 10%, max 2min continuous use, rest 18 minutes
- * Operating Temperature: -10°C~+70°C



Dimensions

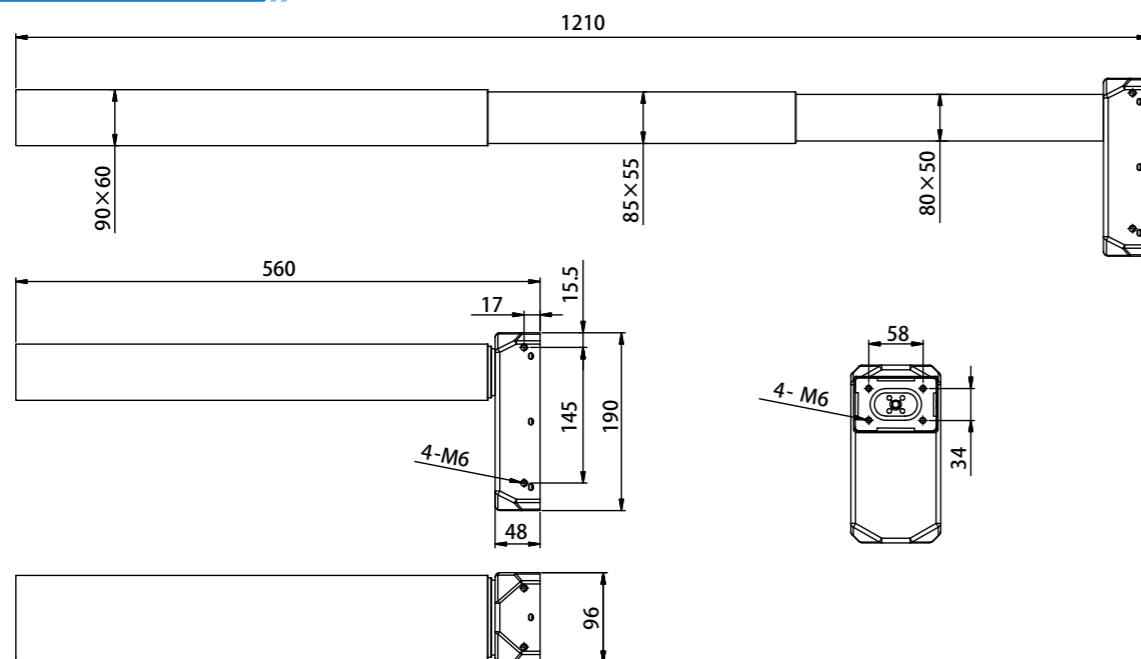

Specifications

NKLC11-3-S

- * With 2mm thickness rectangle tube and 3mm optimized motor housing design for extra strength and stability
- * The tube is no hole design
- * Max. load capacity is 800N per column.
- * Self Locking: 1200N
- * Typical current at rated Load(A): 5A
- * Fit with NKCB11-14 series control boxes to realize stable speed 35mm/s
- * Low noise level ≤50dB
- * Max. Bending moment: 150N.m
- * Standard installation length: 560mm
- * Standard stroke length: 650mm
- * Column dimensions: outer tube: 90x60mm; middle tube: 80x50mm; inner tube :70x40mm
- * Motor housing dimension: 190x96x48mm
- * Motor: Self made high power motor
- * Hall sensor enabling parallel drive
- * Surface: Powder coating with standard
- * Color: White, Black, Grey
- * Optional: Customized colors; Compatible with several different styles of feet; PVC-free column
- * Duty Cycle: 10%, max 2min continuous use, rest 18 minutes
- * Operating Temperature: -10°C~+70°C



Dimensions

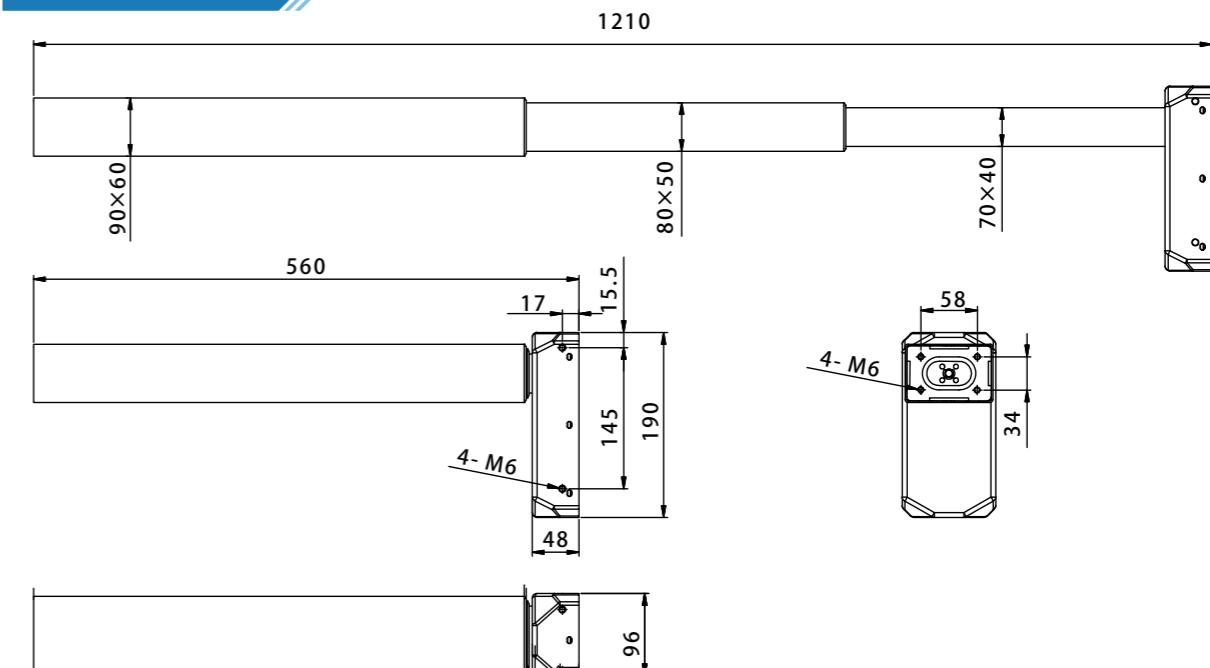

Specifications

NKLC12-3-S

- * With 3mm optimized motor housing design for extra strength and stability
- * Max. load capacity is 800N per column
- * Self Locking: 1200N
- * Typical current at rated Load(A): 5A
- * Fit with NKCB11-14 series control boxes to realize stable speed 35mm/s
- * Low noise level ≤ 50 dB
- * Max. Bending moment: 150N.m
- * Standard installation length: 560mm
- * Standard stroke length: 650mm
- * Column dimensions: outer tube: 95x65mm; middle tube: 90x60mm; inner tube: 85x55mm;
- * Motor housing dimension: 190x96x48mm
- * Motor: Self made high power motor
- * Hall sensor enabling parallel drive
- * Surface: Powder coating with standard
- * Color: White, Black, Grey
- * Optional: Customized colors; Compatible with several different styles of feet; PVC-free column
- * Duty Cycle: 10%, max 2min continuous use, rest 18 minutes
- * Operating Temperature: $-10^{\circ}\text{C} \sim +70^{\circ}\text{C}$



Dimensions

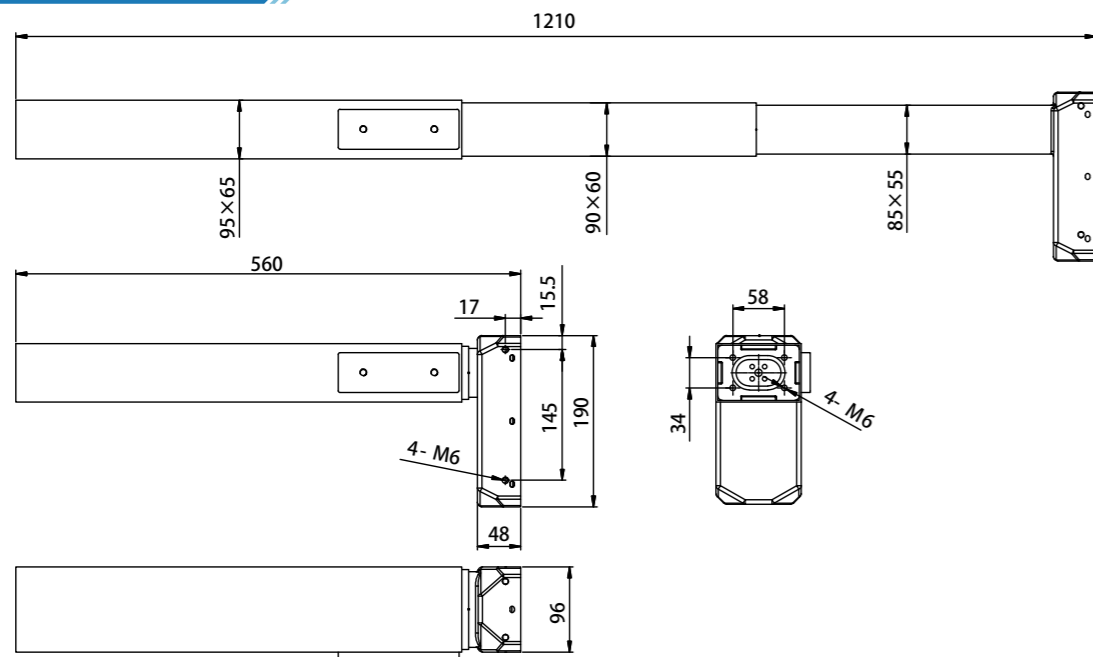

Specifications

NKLC13-3-S

- * NKLC13-3-S is a square shape 3-segment no hole column with smooth and concise design of shape, fit for a wide range of different applications from industry to office desks.
- * The system has a very low standby power consumption less than 0.1W.
- * 2mm thickness round tube and 3mm optimized motor housing design for extra strength and stability
- * The tube is no hole design
- * Max. load capacity is 800N per column
- * Self Locking: 1200N
- * Typical current at rated Load(A): 5A
- * Fit with NKCB11-14 series control boxes to realize stable speed 35mm/s
- * Low noise level < 50 dB
- * Max. Bending moment: 150N.m
- * Standard installation length: 560mm
- * Standard stroke length: 650mm
- * Column dimensions: outer tube: 70x70mm; middle tube: 65x65mm, inner tube: 60x60mm
- * Motor housing dimension: 190x96x48mm
- * Motor: Self made high power motor
- * Hall sensor enabling parallel drive
- * Surface: Powder coating with standard
- * Color: White, Black, Grey
- * Optional: Customized colors; Compatible with several different styles of feet; PVC-free column
- * Duty Cycle: 10%, max 2min continuous use, rest 18 minutes
- * Operating Temperature: $-10^{\circ}\text{C} \sim +70^{\circ}\text{C}$



Dimensions

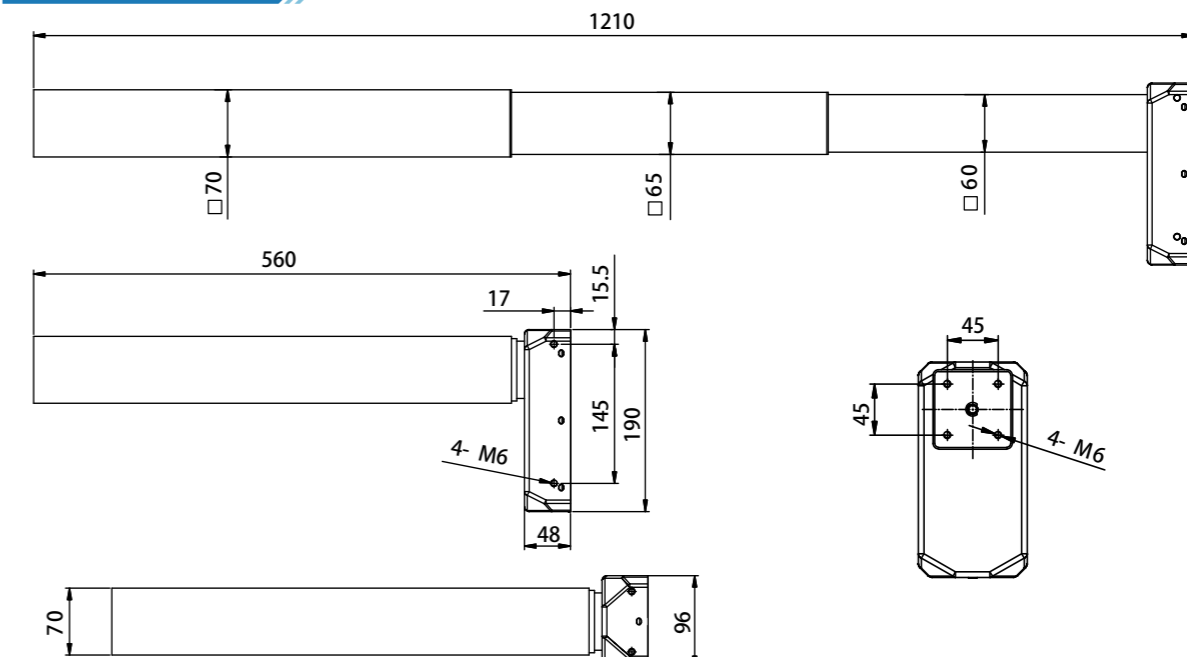

Specifications

NKLC13-3-R

- * Triangular support block design and optimized motor housing for extra strength and stability
- * The tube is no hole design
- * Max. load capacity is 800N per column.
- * Self Locking: 1200N
- * Typical current at rated Load(A): 5A
- * Fit with NKCB11-14 series control boxes to realize stable speed 35mm/s
- * Low noise level $\leq 50\text{dB}$
- * Max. Bending moment: 150N.m
- * Standard installation length: 560mm
- * Standard stroke length: 650mm
- * Column dimensions: outer tube:70x70mm; middle tube: 65x65mm, inner tube: 60x60mm
- * Motor housing dimension: 190x96x48mm
- * Motor: Self made high power motor
- * Hall sensor enabling parallel drive
- * Surface: Powder coating with standard
- * Color: White, Black, Grey
- * Optional: Customized colors; Compatible with several different styles of feet; PVC-free column
- * Duty Cycle: 10%, max 2min continuous use, rest 18 minutes
- * Operating Temperature: $-10^{\circ}\text{C}\sim+70^{\circ}\text{C}$



Dimensions

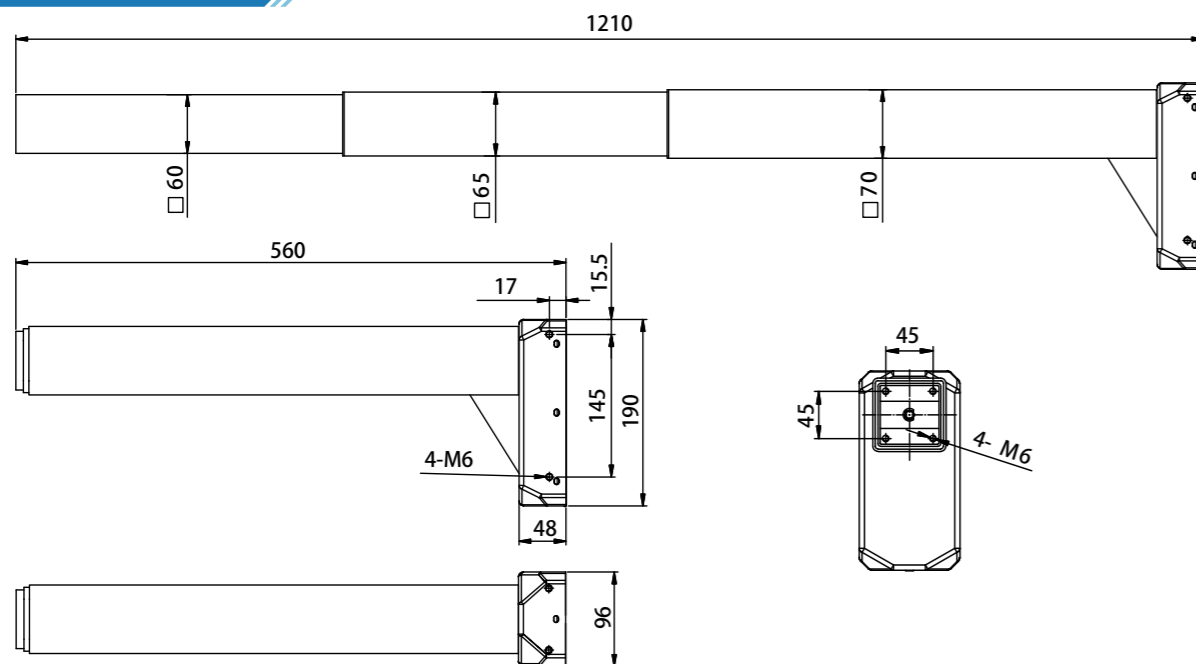

Specifications

NKLC14-3-S

- * 2mm thickness round tube and 3mm optimized motor housing design for extra strength and stability
- * Max. load capacity is 800N per column
- * Self Locking: 1200N
- * Typical current at rated Load(A): 5A
- * Fit with NKCB11-14 series control boxes to realize stable speed 35mm/s
- * Low noise level $\leq 50\text{dB}$
- * Max. Bending moment: 150N.m
- * Standard installation length: 560mm
- * Standard stroke length: 650mm
- * Column dimensions: outer tube 70x70mm; middle tube: 60x60mm, inner tube: 50x50mm
- * Motor housing dimension: 190x96x48mm
- * Motor: Self made high power motor
- * Hall sensor enabling parallel drive
- * Surface: Powder coating with standard
- * Color: White, Black, Grey
- * Optional: Customized colors; Compatible with several different styles of feet; PVC-free column
- * Duty Cycle: 10%, max 2min continuous use, rest 18 minutes
- * Operating Temperature: $-10^{\circ}\text{C}\sim+70^{\circ}\text{C}$



Dimensions

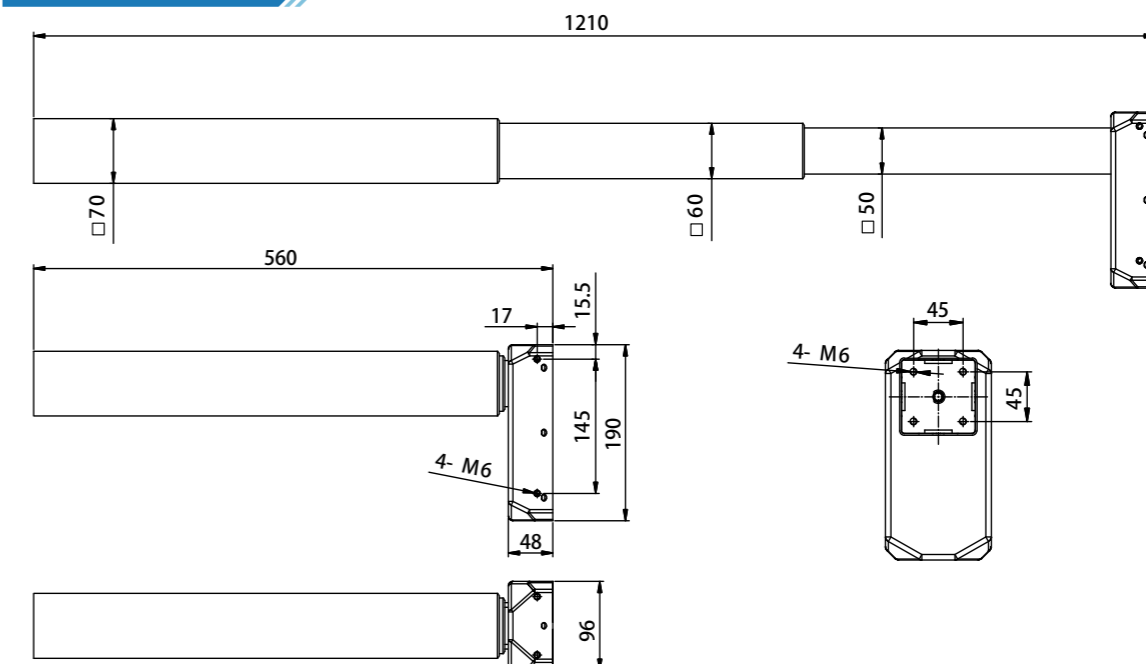

Specifications

NKLC29-2-S

- * With 1.5mm thickness square tube and 3mm optimized motor housing design for extra strength and stability.
- * The tube is no hole design
- * The single column max load capacity: 800N
- * Self Locking: 1200N
- * Typical current at rated Load(A): 5A
- * Fit with NKCB11-14 series control boxes to realize stable speed 32mm/s
- * Low noise level <50dB
- * Max. Bending moment: 150N.m
- * Standard installation length: 650mm
- * Standard stroke length: 500mm
- * Outer tube size: 65×65mm of square shape
- * Motor housing dimension: 190x96x48mm
- * Motor: Self made high power motor
- * Hall sensor enabling parallel drive
- * Surface: Powder coating with standard
- * Color: White, Black, Grey
- * Optional: Customized colors; Compatible with several different styles of feet; PVC-free column; Bracket for crossbar
- * Duty Cycle: 10%, max 2min continuous use, rest 18 minutes
- * Operating Temperature: -10°C~+70°C



Dimensions

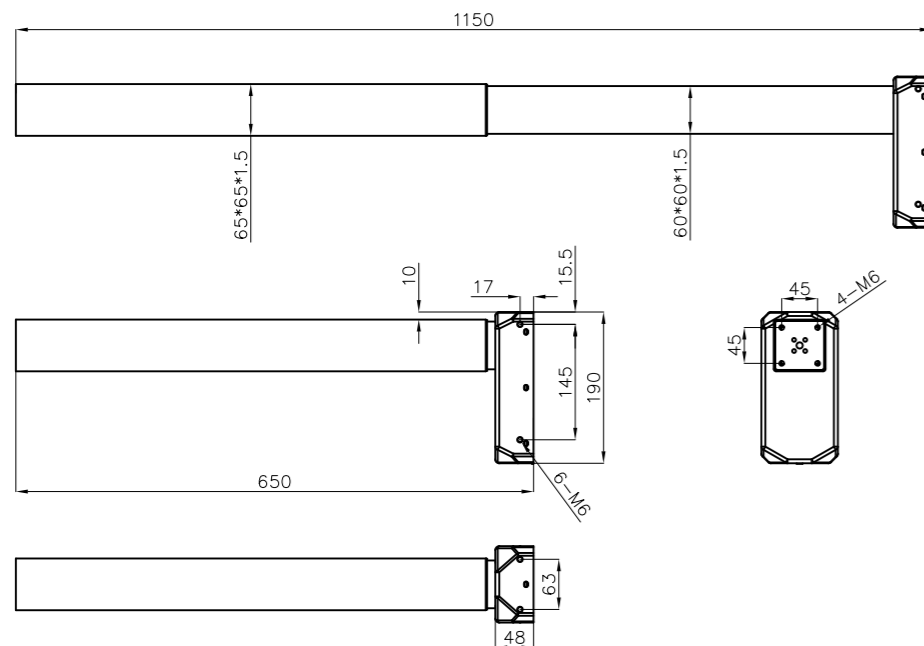

Specifications

NKLC29-3-S

- * With 1.5mm thickness square tube and 3mm optimized motor housing design for extra strength and stability.
- * The tube is no hole design
- * The single column max load capacity: 800N
- * Self Locking: 1200N
- * Typical current at rated Load(A): 5A
- * Fit with NKCB11-14 series control boxes to realize stable speed 35mm/s
- * Low noise level <50dB
- * Max. Bending moment: 150N.m
- * Standard installation length: 560mm
- * Standard stroke length: 650mm
- * Outer tube size: 65×65mm of square shape
- * Motor housing dimension: 190x96x48mm
- * Motor: Self made high power motor
- * Hall sensor enabling parallel drive
- * Surface: Powder coating with standard
- * Color: White, Black, Grey
- * Optional: Customized colors; Compatible with several different styles of feet; PVC-free column; Bracket for crossbar
- * Duty Cycle: 10%, max 2min continuous use, rest 18 minutes
- * Operating Temperature: -10°C~+70°C



Dimensions

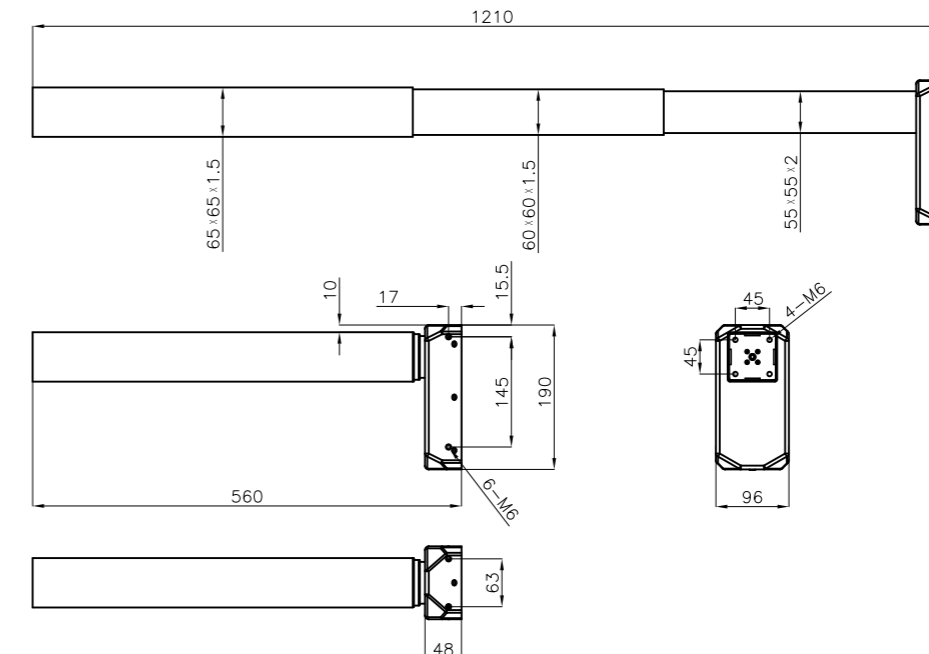

Specifications

NKLC31-2-S

- * With 2mm thickness round tube and 3mm optimized motor housing design for extra strength and stability
- * The tube is no hole design
- * Max. load capacity is 800N per column
- * Self Locking: 1200N
- * Typical current at rated Load(A): 5A
- * Fit with NKCB11-14 series control boxes to realize stable speed 32mm/s
- * Low noise level <50dB
- * Max. Bending moment: 150N.m
- * Standard installation length: 650mm
- * Standard stroke length: 500mm
- * Outer tube size: 91x57mm of oval shape
- * Motor housing dimension: 190x96x48mm
- * Motor: Self made high power motor
- * Hall sensor enabling parallel drive
- * Surface: Powder coating with standard
- * Color: White, Black, Grey
- * Optional: Customized colors; Compatible with several different styles of feet; PVC-free column; Bracket for crossbar
- * Duty Cycle: 10%, max 2min continuous use, rest 18 minutes
- * Operating Temperature: -10°C~+70°C



Dimensions

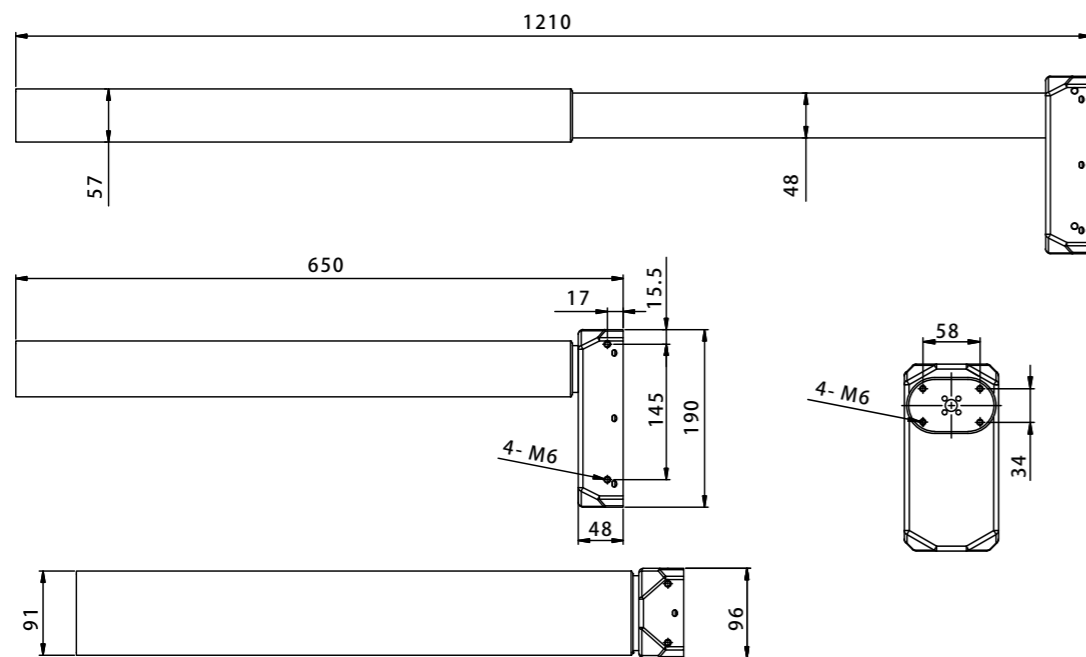

Specifications

NKLC31-3-S

- * With 2mm thickness oval tube and 3mm optimized motor housing design for extra strength and stability
- * The tube is no hole design
- * Max. load capacity is 800N per column
- * Self Locking: 1200N
- * Typical current at rated Load(A): 5A
- * Fit with NKCB11-14 series control boxes to realize max speed 35mm/s
- * Low noise level <50dB
- * Max. Bending moment: 150N.m
- * Standard installation length: 560mm
- * Standard stroke length: 650mm
- * Outer tube size: 91x57mm of oval shape
- * Motor housing dimension: 190x96x48mm
- * Motor: Self made high power motor
- * Hall sensor enabling parallel drive
- * Surface: Powder coating with standard
- * Color: White, Black, Grey
- * Optional: Customized colors; Compatible with several different styles of feet; PVC-free column; Bracket for crossbar
- * Duty Cycle: 10%, max 2min continuous use, rest 18 minutes
- * Operating Temperature: -10°C~+70°C



Dimensions

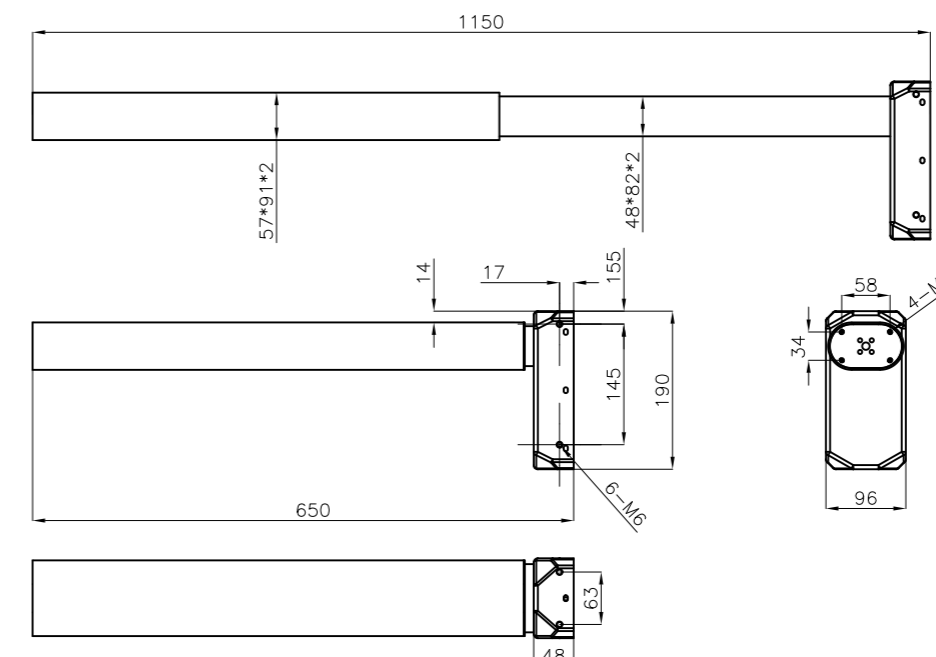

Specifications

NKLC32-3-S

- * With 2mm thickness oval tube and 3mm optimized motor housing design for extra strength and stability
- * The tube is no hole design
- * The single column max load capacity: 800N
- * Self Locking: 1200N
- * Typical current at rated Load(A): 5A
- * Fit with NKCB11-14 series control boxes to realize max speed 35mm/s
- * Low noise level :≤50dB
- * Max. Bending moment: 150N.m
- * Standard installation length: 560mm
- * Standard stroke length: 650mm
- * Outer tube size: 90x60mm of oval shape
- * Motor housing dimension: 190x96x48mm
- * Motor: Self made high power motor
- * Hall sensor enabling parallel drive
- * Surface: Powder coating with standard
- * Color: White, Black, Grey
- * Optional: Customized colors; Compatible with several different styles of feet; PVC-free column; Bracket for crossbar
- * Duty Cycle: 10%, max 2min continuous use, rest 18 minutes
- * Operating Temperature: -10°C~+70°C



Dimensions

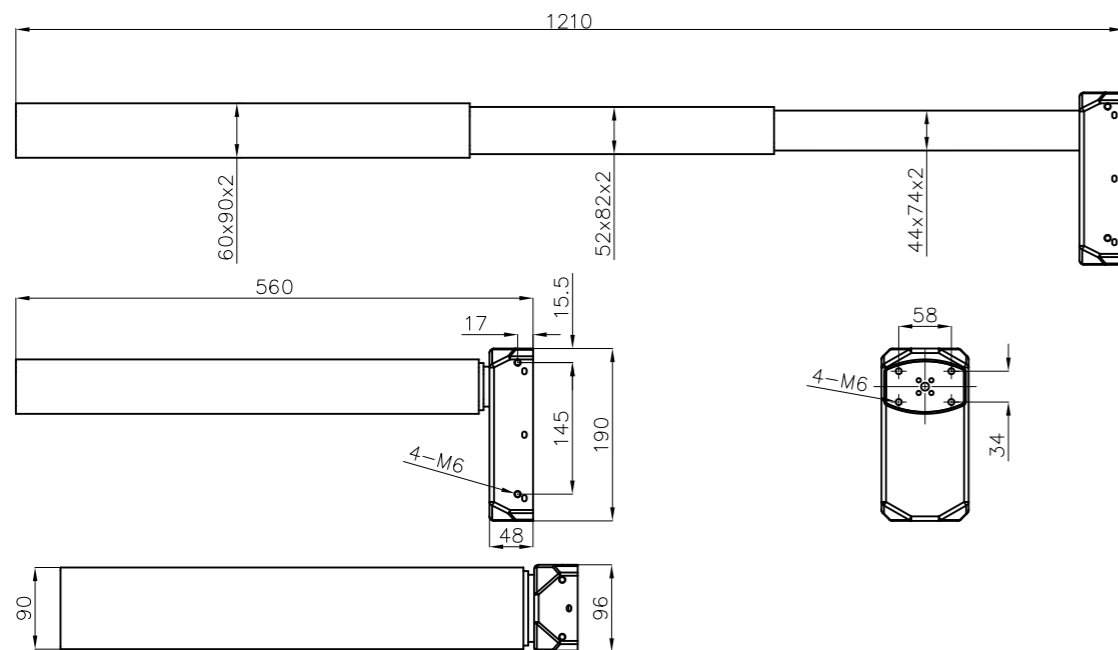

Specifications

NKLC34-3-S-V2

- * The tube is no hole design
- * The single column max load capacity: 700N
- * Self Locking: 1000N
- * Typical current at rated Load(A): 6A
- * Fit with NKCB11-14 series control boxes to realize max speed 35mm/s
- * Low noise level ≤50dB
- * Max. Bending moment: 150N.m
- * Standard installation length: 518mm
- * Standard stroke length: 660mm
- * Outer tube size: 95x65x1.5mm
- * Motor: Self made high power motor
- * Hall sensor enabling parallel drive
- * Surface: Powder coating with standard
- * Color: White, Black, Grey
- * Optional: Customized colors; Compatible with several different styles of feet; PVC-free column; Bracket for crossbar
- * Duty Cycle: 10%, max 2min continuous use, rest 18 minutes
- * Operating Temperature: -10°C~+70°C



Dimensions

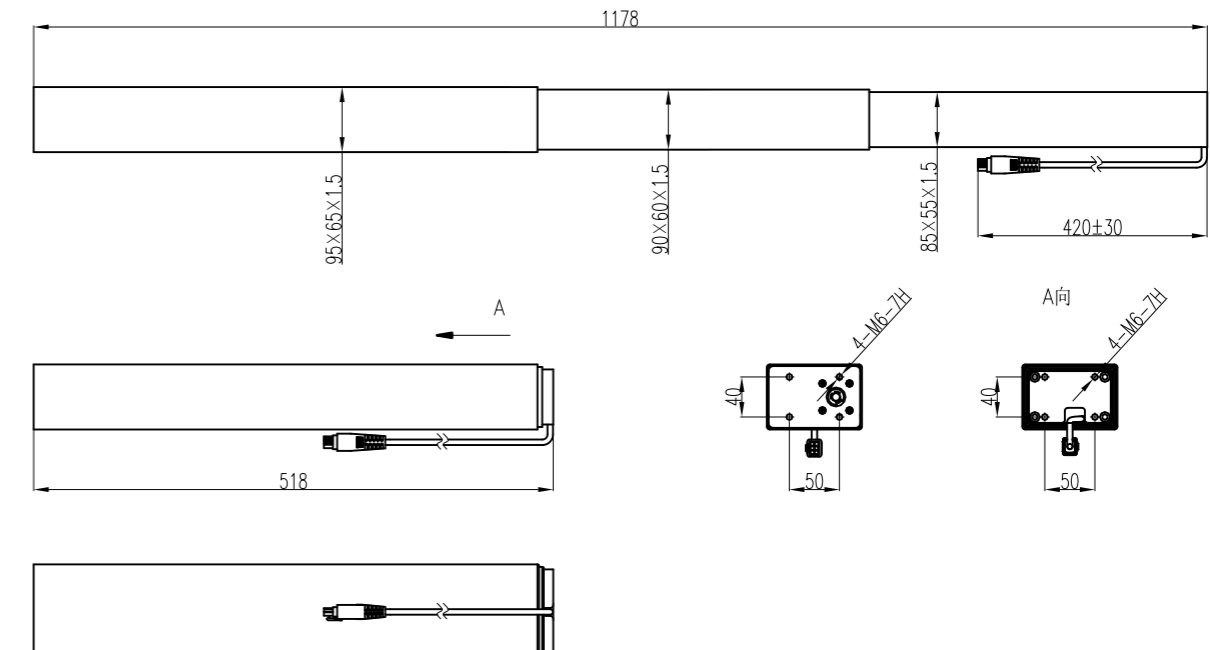

Specifications

NKLC35-2-S

- * With 1.5mm thickness square tube and 3mm optimized motor housing design for extra strength and stability.
- * The tube is no hole design
- * The single column max load capacity: 800N
- * Self Locking: 1200N
- * Typical current at rated Load(A): 5A
- * Fit with NKCB11-14 series control boxes to realize max speed 32mm/s
- * Low noise level <50dB
- * Max. Bending moment:150N.m
- * Standard installation length: 650mm Standard stroke length: 500mm
Outer tube size:75×75mm of square shape
- * Motor housing dimension:190×96×48mm
- * Motor: Self made high power motor
- * Hall sensor enabling parallel drive
- * Color: White, Black, Grey
- * Optional: Customized colors; Compatible with several different styles of feet; PVC-free column; Bracket for crossbar
- * Duty Cycle: 10%, max 2min continuous use, rest 18 minutes
- * Operating Temperature: -10°C~+70°C



Dimensions

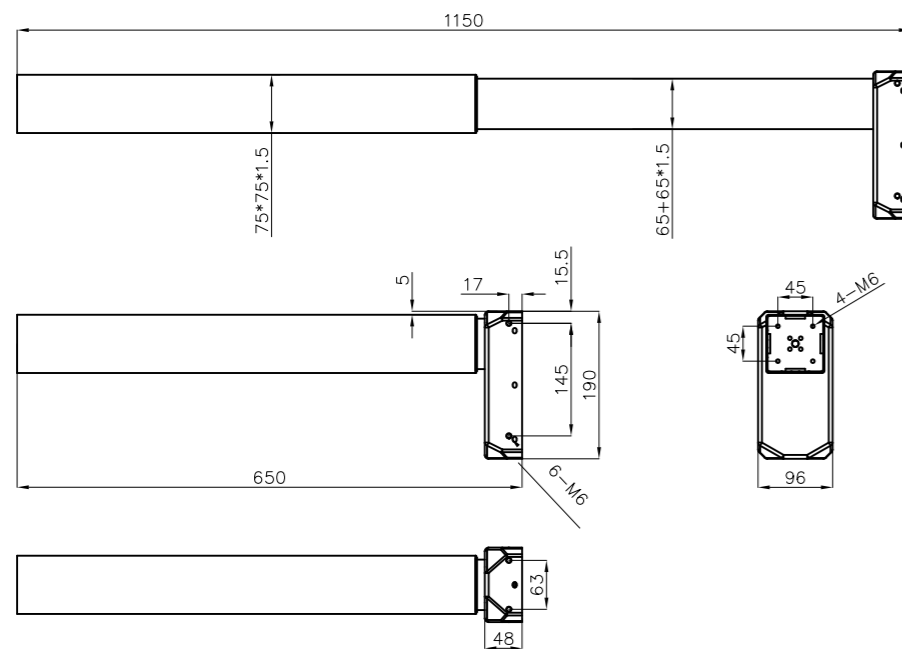

Specifications

NKLC35-3-S

- * With 1.5mm thickness square tube and 3mm optimized motor housing design for extra strength and stability.
- * The tube is no hole design
- * The single column max load capacity: 800N
- * Self Locking: 1200N
- * Typical current at rated Load(A): 5A
- * Fit with NKCB11-14 series control boxes to realize max speed 35mm/s
- * Low noise level <50dB
- * Max. Bending moment:150N.m
- * Standard installation length: 560mm
Standard stroke length: 650mm
Outer tube size:75×75mm of square shape
- * Motor housing dimension:190×96×48mm
- * Motor: Self made high power motor
- * Hall sensor enabling parallel drive
- * Color: White, Black, Grey
- * Optional: Customized colors; Compatible with several different styles of feet; PVC-free column; Bracket for crossbar
- * Duty Cycle: 10%, max 2min continuous use, rest 18 minutes
- * Operating Temperature: -10°C~+70°C

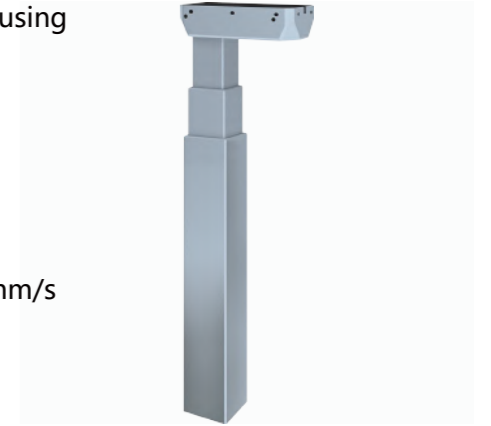

Dimensions

